



**Sheraton®**

INDIANAPOLIS HOTEL  
AT KEYSTONE CROSSING

# Conference Center Fact Sheet



## Welcome to

Sheraton Indianapolis Hotel at Keystone Crossing, located in the city's most prestigious area, Keystone at the Crossing. We are easily accessible from both downtown and Indianapolis International Airport (IND), making our north-side landmark a great choice for individual travelers and groups of any size.

### Explore

The Fashion Mall is connected to our hotel by a skywalk and offers more than 200 upscale stores. Our location allows you easy access to exciting sports attractions, interesting cultural events, and some of Indy's finest dining options.

### Experience

We feature 30,000 square feet of meeting space and a technologically advanced conference environment, offering a memorable experience for meeting or personal gatherings.

### Stay

With 395 deluxe guestrooms and suites, the Sheraton is the ideal destination for every occasion, from family getaways to business stays. The superb location of the hotel allows outstanding views of the city.

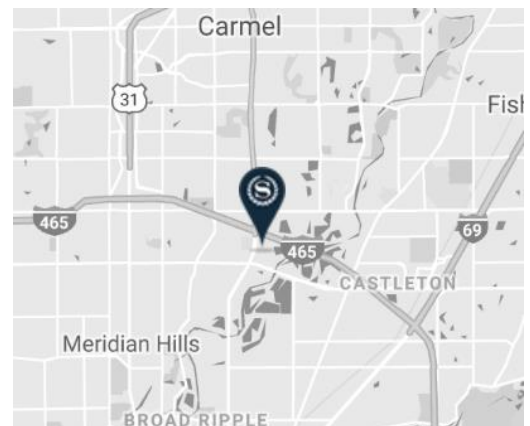

Sheraton Indianapolis Hotel at Keystone Crossing  
8787 Keystone Crossing  
Indianapolis, IN 46240  
317.846.2700

[www.sheratonindianapoliskeystone.com](http://www.sheratonindianapoliskeystone.com)



**Sheraton**<sup>®</sup>

INDIANAPOLIS HOTEL  
AT KEYSTONE CROSSING

# Conference Center Fact Sheet

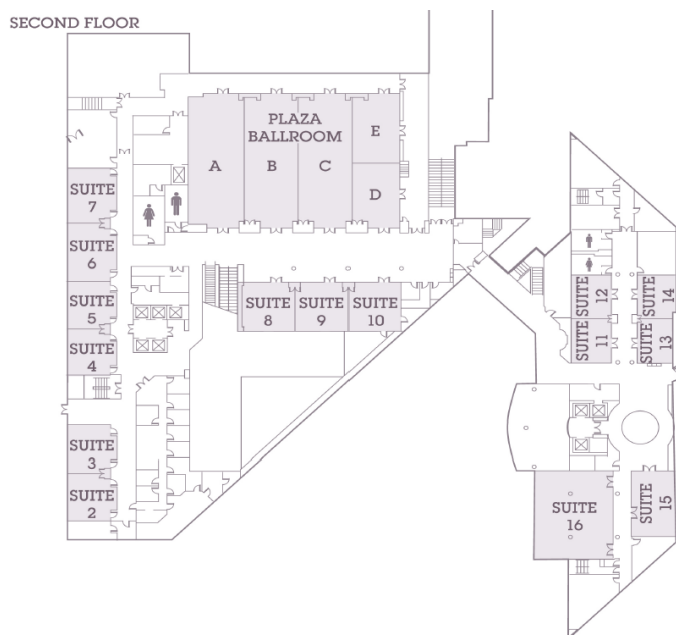
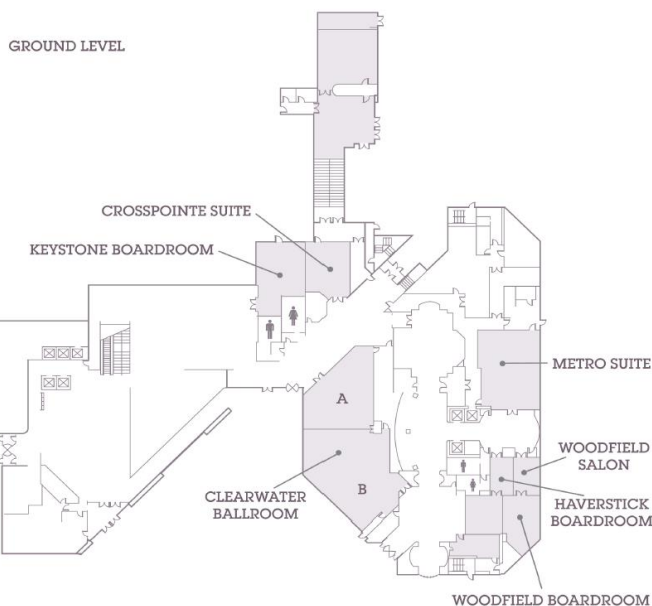

Meeting Room Name	Length (Ft)	Length (M)	Width (Ft)	Width (M)	Height (Ft)	Height (M)	Area (Sq Ft)	Area (Sq M)	Theater	Classr oom	Confer ence	U-Shape	Hollow Sq.	Rounds (8)	Rounds (10)
<b>Ground Floor</b>															
Haverstick Board Room	22	6.71	20	6.10	9.5	2.90	440	41			12				
Woodfield Board Room	23	7.01	20	6.10	9.5	2.90	460	43			16				
Woodfield Salon	22	6.71	15	4.57	9.5	2.90	330	31							
Metro Suite	35	10.67	47	14.33	9.5	2.90	1645	153	178	96	51	42	51	88	110
Clearwater Ballroom A	41	12.50	39	11.89	11	3.35	1599	183	120	40	35	35	35	110	130
Clearwater Ballroom B	47	14.33	42	12.80	11	3.35	1974	183	180	75	50	40	40	120	160
<b>Clearwater Ballroom</b>	<b>88</b>	<b>26.82</b>	<b>47</b>	<b>14.33</b>	<b>11</b>	<b>3.35</b>	<b>4136</b>	<b>384</b>	<b>300</b>	<b>150</b>	<b>85</b>	<b>75</b>	<b>85</b>	<b>230</b>	<b>300</b>
Crosspointe Suite	24	7.32	33	10.06	10	3.05	792	74	45	30	20	15	20	40	50
Keystone Board Room	46	14.02	23	7.01	10	3.05	1058	98	70	50	20	30	36	48	60
Crosspointe/Keystone Salon	70	21.34	56	17.07	10	3.05	1850	364							
<b>Second Floor</b>															
Plaza A	29	8.84	68	20.73	14	4.27	1972	183	245	140	70	66	70	144	180
Plaza B	27.5	8.38	68	20.73	14	4.27	1870	174	235	120	70	66	70	96	120
Plaza C	27.5	8.38	68	20.73	14	4.27	1870		235	120	70	66	70	96	120
Plaza D	24	7.32	32.5	9.91	14	4.27	780	72	100	50	35	30	35	30	60
Plaza E	24	7.32	35.5	10.82	14	4.27	852	79	100	50	35	30	35	30	60
<b>Plaza Ballroom</b>	<b>68</b>	<b>20.73</b>	<b>108</b>	<b>32.92</b>	<b>14</b>	<b>4.27</b>	<b>7344</b>	<b>682</b>	<b>1000</b>	<b>500</b>	<b>144</b>	<b>99</b>	<b>144</b>	<b>480</b>	<b>660</b>
Suite 2	24	7.32	26.5	8.08	9	2.74	636	59	40	30	20	15	20	32	40
Suite 3	24	7.32	26.5	8.08	9	2.74	636	59	40	30	20	15	20	32	40
Suite 2-3	24	7.32	53	16.15	9	2.74	1272	118	100	65	40	30	40	72	90
Suite 4	24	7.32	26.5	8.08	9	2.74	636	59	40	30	20	15	20	32	40
Suite 5	24	7.32	26.5	8.08	9	2.74	636	59	40	30	20	15	20	32	40
Suite 4-5	24	7.32	53	16.15	9	2.74	1272	118	100	65	40	30	40	72	90
Suite 6	24	7.32	33	10.06	9	2.74	792	74	50	35	20	20	20	48	60
Suite 7	24	7.32	31	9.45	9	2.74	744	69	50	35	20	20	20	48	60
Suite 6-7	24	7.32	64	19.51	9	2.74	1536	143	125	75	40	40	40	96	120
Suite 8	26	7.92	27	8.23	10	3.05	702	65	50	30	20	20	20	32	40
Suite 9	26	7.92	27	8.23	10	3.05	702	65	50	30	20	20	20	32	40
Suite 10	26	7.92	27	8.23	10	3.05	702	65	50	30	20	20	20	32	40
Suite 8-10	26	7.92	80	24.38	10	3.05	2080	193	190	100	70	65	65	96	120
Suite 11	20	6.10	25	7.62	9	2.74	500	46	40	24	20	15	20	24	30
Suite 12	20	6.10	23	7.01	9	2.74	460	43	40	24	20	15	20	24	30
Suite 11-12	20	6.10	48	14.63	9	2.74	960	89	80	45	30	25	30	30	60
Suite 13	17	5.18	25	7.62	9	2.74	425	39	30	24	15	12	15	16	20
Suite 14	17	5.18	23	7.01	9	2.74	391	36	25	20	15	12	15	16	20
Suite 13-14	17	5.18	48	14.63	9	2.74	816		60	40	25	20	25	32	40
Suite 15	36	10.97	21	6.40	9	2.74	756	70	70	35	30	25	30	40	50
Suite 16	49	14.94	39	11.89	9	2.74	1911	178	160	75	40	36	40	120	140
<b>Third Floor</b>															
<b>Plaza Board Room</b>	<b>26</b>	<b>7.92</b>	<b>23</b>	<b>7.01</b>	<b>9</b>	<b>2.74</b>	<b>598</b>	<b>56</b>	<b>50</b>	<b>30</b>	<b>20</b>	<b>20</b>	<b>26</b>	<b>32</b>	<b>40</b>
Patio	31	9.45	43	13.11			1333	124							
<b>Plaza Board Room &amp; Patio</b>	<b>57</b>	<b>17.37</b>	<b>66</b>	<b>20.12</b>	<b>9</b>	<b>2.74</b>	<b>1931</b>	<b>350</b>							