



WESTIN[®]
HOTELS & RESORTS

Meaningful Connections

Connect with colleagues and explore new ideas when you host your meeting at The Westin Houston, Memorial City. We help you work well by removing the distractions, so your group can focus on the business at hand for an effective and successful session. With our vibrant, comfortable rooms, thoughtful amenities and central location, we also help you stay well and explore more.

**THE WESTIN HOUSTON,
MEMORIAL CITY**

945 Gessner Road
Houston, TX 77024
United States

T +1 281.501.4300
westinhoustonmemorialcity.com

Set for Success

Our Clutter-Free Meetings help you stay organized and productive with an open-room design, socially conscious amenities and delicious SuperFoodsRx™ menu choices to keep minds sharp and well nourished. Streamlined stations provide paper, pens and beverages to keep individual work areas neat and clear. Work eco-friendly with thoughtful “green” features such as energy-efficient light bulbs, double-sided notepads, and water pitchers to replace water bottles and reduce waste.

Whether you're hosting 25 friends or 1,000 conference attendees, our seasoned planning specialist will assist you with every detail. We offer a variety of innovative tools to help you book meetings with ease, including a free, customized website where attendees can book reservations as well as access documents via a unique URL. Designed with the meeting planner in mind, our personalized services help effortlessly provide a memorable experience for each and every invitee.

Fitness and Free Time

Reenergize with a selection of weight machines, free weights and cardiovascular equipment at the hotel's WestinWORKOUT® Fitness Studio, open 24 hours a day. Recharge with a swim in the hotel's 18-floor pool. Or rejuvenate with an in-room massage treatment, which we can help arrange. Other amenities include a business center, a gift shop, an ATM and a Hertz rental car desk.

Enriching Details

The hotel offers a total of 29 meeting rooms with more than 33,000 square feet of sophisticated, unconstrained accommodations. Our versatile event space is anchored by the grand 10,425-square-foot Azalea Ballroom, an elegant choice for weddings and other social or business occasions with a guest list of up to 1,043 invitees.

All of our spaces are equipped with high-speed Wi-Fi, state-of-the-art audiovisual services and creative, customized menu options that ensure your event will be most memorable and entirely one of a kind.

Whether you're a meeting planner or a bride-to-be, take comfort in knowing that the staff at The Westin Houston, Memorial City thrives on satisfying your every need, no matter how personalized.





Capacity Charts

ROOM NAME	SQUARE FEET	DIMENSIONS	CEILING	THEATER	CLASS 3 PER 6' TABLE	CLASS 2 PER 6' TABLE	CONFERENCE	U-SHAPE	RECEPTION	BANQUET
4TH FLOOR										
AZALEA BALLROOM	10,425	119' X 91'	18' - 19'6"	957	573	382	—	—	1,043	780
AZALEA 1	1,766	39' X 45'	18' - 19'6"	160	96	64	34	36	177	120
AZALEA 2	1,796	39' X 46'	18' - 19'6"	160	96	64	34	36	180	110
AZALEA 3	3,675	40' X 91'	18' - 19'6"	320	192	128	—	84	368	240
AZALEA 4	1,035	31' X 39'	18' - 19'6"	96	51	34	28	27	104	80
AZALEA 5	1,076	27' X 39'	18' - 19'6"	92	60	40	28	33	108	60
AZALEA 6	1,077	31' X 39'	18' - 19'6"	84	60	40	28	27	108	70
AZALEA 1 & 2	3,526	39' X 91'	18' - 19'6"	320	204	136	—	—	353	240
AZALEA 1, 2 & 3	7,237	79' X 91'	18' - 19'6"	680	432	288	—	—	724	540
AZALEA 4, 5 & 6	3,188	39' X 91'	18' - 19'6"	313	174	116	—	—	319	200
AZALEA 4 & 5	2,111	39' X 58'	18' - 19'6"	197	105	70	—	—	211	140
AZALEA 5 & 6	2,153	39' X 58'	18' - 19'6"	176	111	74	—	—	215	140
AZALEA 3, 4, 5 & 6	6,863	79' X 91'	18' - 19'6"	620	405	270	—	—	686	510
AZALEA PREFUNCTION	4,506	103' X 217'	12'	—	—	—	—	—	350	—
CEDAR	740	22' X 34'	11'6" - 12'	63	30	20	28	24	74	50
CYPRESS	1,061	25' X 43'	11'6" - 12'	82	42	28	34	36	106	80
PECAN	906	20' X 46'	11'6" - 12'	53	42	28	40	33	91	60
ELM	437	18' X 25'	11'6" - 12'	25	12	8	16	—	44	20
PINE	588	22' X 28'	9'6" - 10'	44	24	16	22	18	59	40
WILLOW	1,325	28' X 44'	11' - 11'6"	90	60	40	40	36	133	80
COTTONWOOD BOARDROOM	793	25' X 32'	12' - 12'6"	—	—	—	22	—	—	—
COTTONWOOD FOYER	315	14' X 23'	12' - 12'6"	—	—	—	—	—	—	—
3RD FLOOR										
WISTERIA BALLROOM	5,657	103' X 55'	13'6" - 15'6"	564	324	216	—	—	566	430
WISTERIA 1	1,767	31' X 55'	13'6" - 15'6"	144	120	80	46	45	177	140
WISTERIA 2	1,788	32' X 55'	13'6" - 15'6"	168	120	80	46	42	179	140
WISTERIA 3	1,028	39' X 27'	13'6" - 15'6"	93	60	40	28	24	103	60
WISTERIA 4	1,074	39' X 28'	13'6" - 15'6"	90	60	40	28	33	107	60
WISTERIA 1 & 2	3,555	63' X 55'	13'6" - 15'6"	300	210	140	—	—	356	280
WISTERIA 3 & 4	2,102	39' X 55'	13'6" - 15'6"	168	120	80	46	45	210	140
WISTERIA 2, 3 & 4	3,890	71' X 55'	13'6" - 15'6"	384	216	144	—	—	389	240
WISTERIA PREFUNCTION	3,384	79' X 246'	15'	—	—	—	—	—	250	—
HIBISCUS BALLROOM	2,030	68' X 32'	14' - 16'	135	80	52	—	60	200	110
HIBISCUS 1	598	22' X 28'	14' - 16'	49	24	16	22	18	60	40
HIBISCUS 2	624	20' X 32'	14' - 16'	55	30	20	28	24	62	40
HIBISCUS 3	808	26' X 32'	14' - 16'	50	42	28	22	24	81	50
MESQUITE	797	25' X 32'	14' - 16'	56	30	20	28	21	80	60
SUNFLOWER	627	24' X 26'	14' - 16'	50	36	24	22	18	63	40
2ND FLOOR										
MAGNOLIA BALLROOM	3,598	98' X 37'	12' - 14'	270	169	112	—	—	350	220
MAGNOLIA 1	763	21' X 37'	12' - 14'	65	33	22	31	33	76	40
MAGNOLIA 2	962	26' X 37'	12' - 14'	98	51	34	34	36	90	60
MAGNOLIA 3	964	26' X 37'	12' - 14'	98	51	34	34	36	90	60
MAGNOLIA 4	958	26' X 37'	12' - 14'	58	45	30	30	33	90	50
MAGNOLIA PREFUNCTION	1,998	54' X 136'	13'	—	—	—	—	—	200	—
LANTANA	614	20' X 31'	12' - 14'	50	30	20	28	24	61	40
LILY	772	26' X 31'	12' - 14'	84	36	24	24	24	77	50

Floor Plans

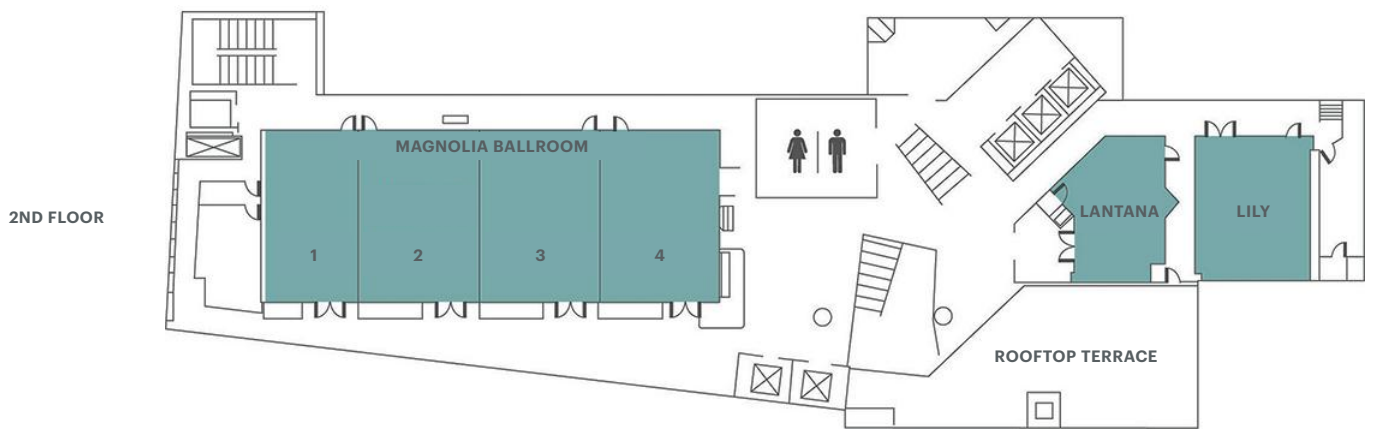
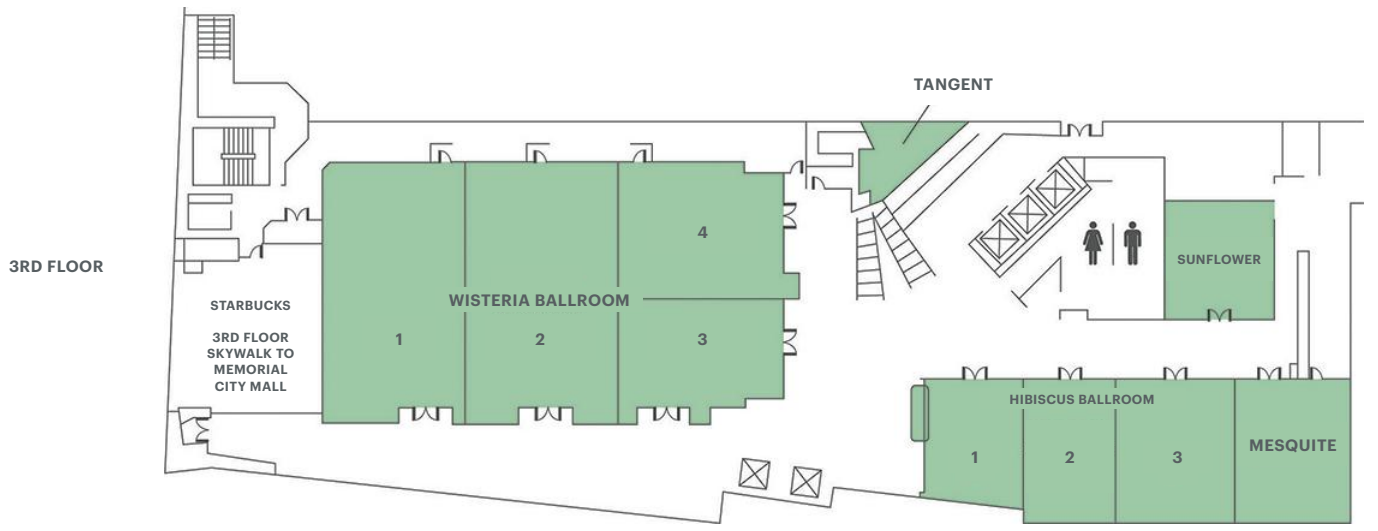
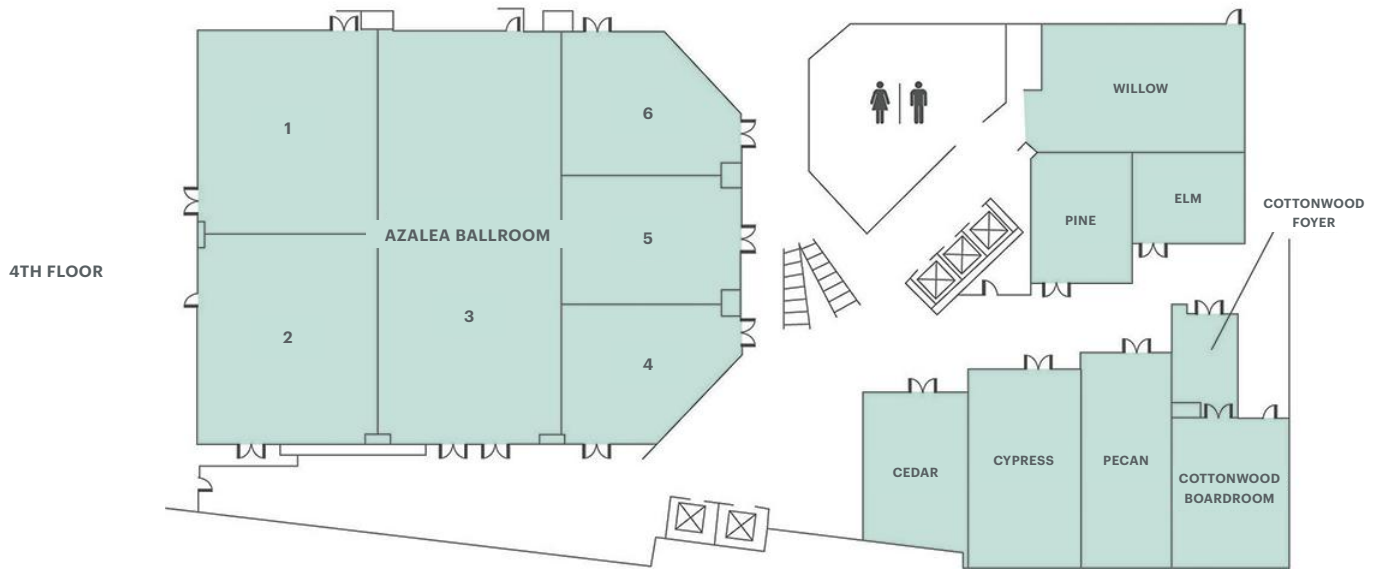

Perfectly Located

The Westin Houston, Memorial City is conveniently connected to the Gateway Lifestyle Center, Memorial City Mall and Memorial Hermann Memorial City Medical Center in Houston's vibrant and evolving Memorial City area.

The hotel's central location provides easy access to lively nightlife and dining, invigorating shopping and an abundance of Houston's most visited cultural venues and vibrant attractions.

Rest Assured

Stay in restful comfort in one of 289 contemporary and relaxing guest rooms and suites featuring Westin's signature Heavenly® Bed and Heavenly® Bath, Wi-Fi, data port, flat-screen LCD television, work desk with ergonomic chair, in-room safe and gourmet coffee. Westin offers guests a 100% smoke-free environment.

Other thoughtful touches include complimentary daily newspaper delivery, deluxe bath amenities and the convenience of an in-room refrigerator. Traditional rooms average 400 square feet, and Executive Balcony Suites feature sliding glass doors that open to a private patio or balcony.

Reward Yourself

Meeting planners are automatically enrolled in the Marriott Bonvoy™ points program. Whatever occasion you're planning for, you'll earn points on eligible purchases, good for travel, experiences and more.

For more information, please visit marriott.com/loyalty.mi

Visit marriott.com/houmy for directions and reservations.

