

The Glasshouse

EDINBURGH

AUTOGRAPH COLLECTION[®]
HOTELS



The Autograph Collection, by Marriott International, is an evolving ensemble of strikingly independent hotels.

Welcome to The Glasshouse

The venue

Whether you're after a distinctive venue for a meeting, reception or private dining, The Glasshouse combines a handsome history with the benefits of a five-star boutique hotel.

Flanking the gothic facade of Edinburgh's Lady Glenorchy Church soar the clean, contemporary lines of The Glasshouse. Striking a perfect balance between heritage and cutting edge, the harmonious exterior gives way to a coolly contemporary space with a traditional twist. Whatever the occasion, the location and excellent service will ensure an unforgettable event.

In the heart of the city

Known for its iconic architecture and the cultural heritage that saw Edinburgh nicknamed Athens of the North, The Glasshouse is in the heart of the city.

Just a five-minute stroll from Princes Street, Edinburgh Castle and The Royal Mile, it is the perfect location for enjoying all the city has to offer.

Private dining and receptions

Five private dining rooms can cater for breakfast, lunch or dinner for up to 40 guests. For larger parties, the Calton Suite is also available. The private dining rooms are also suitable for evening receptions of up to 30 people.

Our meeting spaces

The Glasshouse features a unique events space, the Calton Suite, The Observatory, two state-of-the-art boardrooms, named after famous Scottish writers - The Walter Scott, and The Louis Stevenson rooms. Two syndicate rooms are also available.

Facilities

Room facilities include LCD projector and screen, flipcharts and stationery. Additional equipment or decorative items can be arranged on your behalf.

The Glasshouse is also available for exclusive hire. A minimum spend applies to all 'exclusive hire' options.

Booking details

Scott McArdle
Conference & Events Manager
D. +44 (0)131 525 8331
E. events@theglasshousehotel.co.uk

The Glasshouse
2 Greenside Place, Edinburgh, EH1 3AA
T. +44 (0)131 525 8200

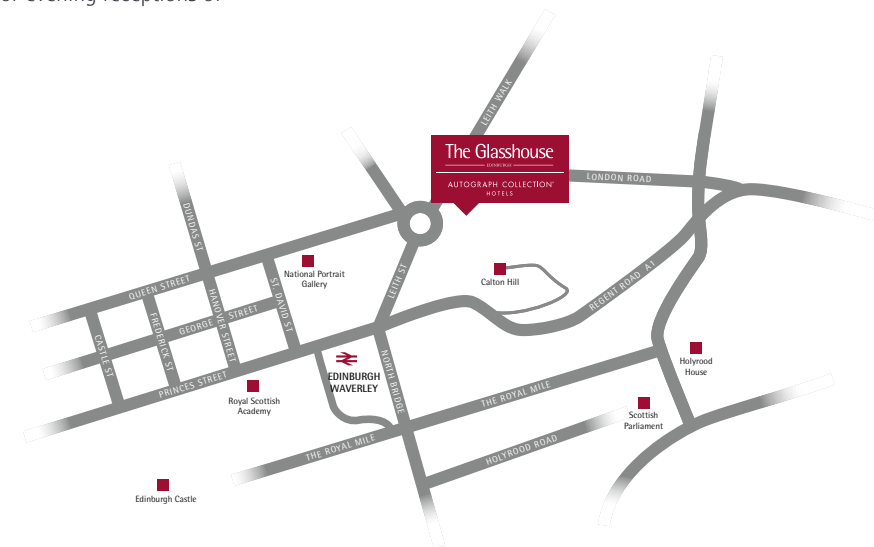

SECOND FLOOR

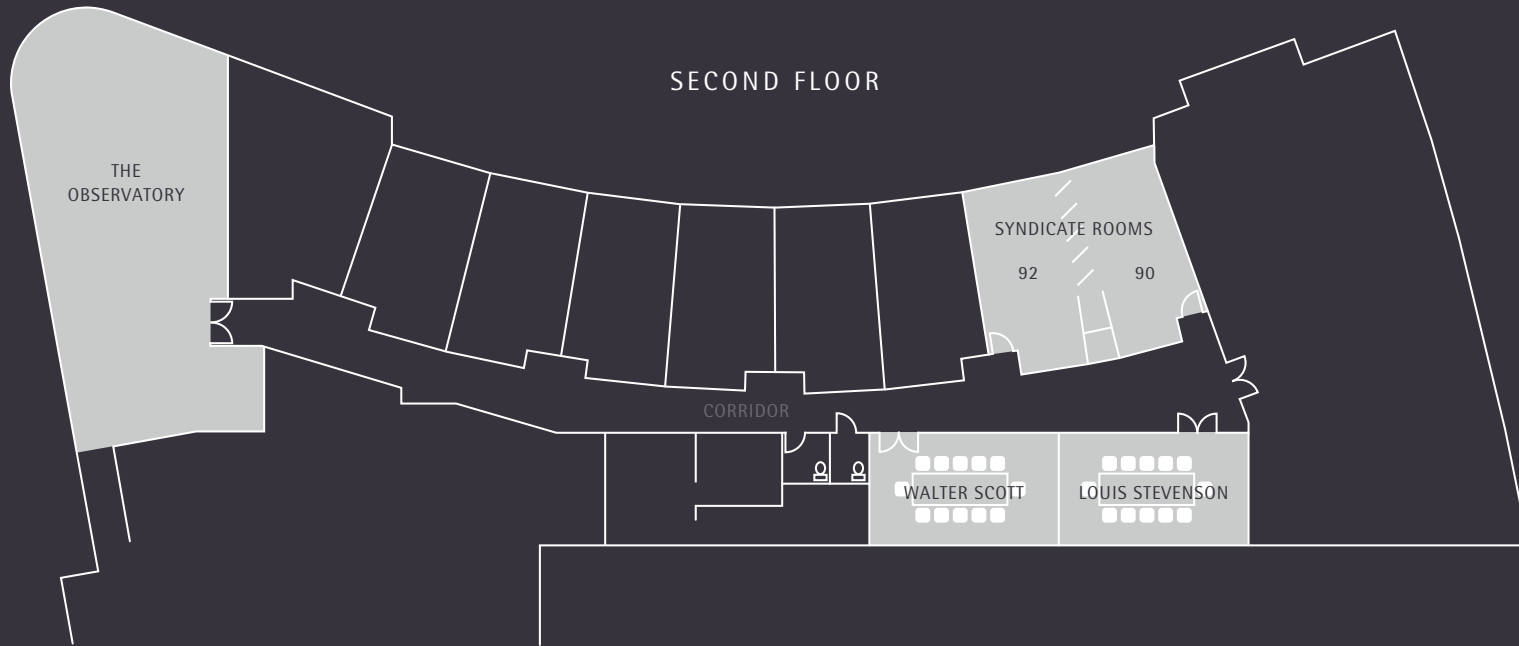

THE WALTER SCOTT



THE LOUIS STEVENSON



SYNDICATE ROOMS 90 / 92



THE OBSERVATORY

:: Meeting spaces

Capacities	Boardroom	Reception	Private Dining	Theatre	Measurements	Floor Area
WALTER SCOTT	12	30	12	20	5.0 x 7.5 x 2.8	37.5
LOUIS STEVENSON	12	30	12	20	5.0 x 7.5 x 2.8	37.5
SYNDICATE ROOMS 90 / 92	6	n/a	6	10	2.4 x 5.0 x 2.8	12
<i>Used as adjoining rooms</i>	15	24	12	20	4.8 x 10.0 x 5.6	24
THE OBSERVATORY [†]	30	80	60	80	7.5 x 15.0 x 2.8	112.5
					w x l x h (m)	(m ²)

Information

Room hire costs and full day delegate rates are available on request by calling 0131 525 8331, or emailing our Conference & Events Manager: events@theglasshousehotel.co.uk

[†]available from 12.30pm only

'This is a city of shifting light, of changing skies, of sudden vistas. A city so beautiful it breaks the heart again and again.'

ALEXANDER MCCALL SMITH



:: The Calton Suite

An oasis in the city...

Set within The Glasshouse's unique, two-acre roof garden, The Calton Suite offers unparalleled views over Edinburgh's Calton Hill and the Firth of Forth.

This is a spectacular backdrop for any private event, from product launches to special celebrations.

Capacities (max)

Standing reception	110
Private dining	80
Theatre style	90
Dinner & dancing	60
Boardroom	40
Cabaret style	50
U-shaped style	30

Information

Measurements (w x l x h):
6.0 x 20.0 x 3m

Floor area: 112.5sqm

Room hire costs and full day delegate rates are available on request by calling 0131 525 8331, or emailing our Conference & Events Manager: events@theglasshousehotel.co.uk

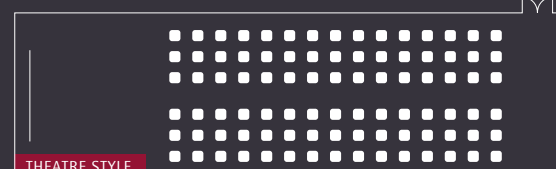
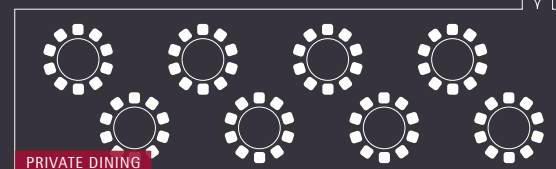

'Talk is by far the most accessible of pleasures.'

ROBERT LOUIS STEVENSON



The Glasshouse

EDINBURGH

AUTOGRAPH COLLECTION
HOTELS

:: The Observatory

A room with a view...

Enjoy arrival drinks and canapés in our unique, two acre, elegantly landscaped, roof-top garden followed by a private dinner in The Observatory.

Overlooking the World Heritage site of Calton Hill, this venue is perfect for a private or corporate event.

Capacities (max)

Boardroom	30
Standing reception	80
Private dining	60
Theatre style	80

Information

Measurements (w x l x h):
7.5 x 15.0 x 2.8m
Floor area: 112.5sqm
Room hire costs and full day delegate rates are available on request by calling 0131 525 8331, or emailing our Conference & Events Manager: events@theglasshousehotel.co.uk

