



EVENTS THAT GO BEYOND THE ORDINARY

The Renaissance Austin Hotel is your group's gateway into unique ventures and collective discoveries. Every inch of our hotel—from the 492 accommodations to the 70,000 square feet of event space—is designed with local artwork and elements so that your group will experience authentic Austin from the moment you meet. From our intimate boardrooms to the outdoor patio to the 30,000-square-foot exhibit hall, you'll find the perfect venue to suit your unique vision. With expert planners and custom caterers on site, we'll create a seamless event experience that's business unusual, whether you're dancing in the ballroom or connecting over barbecue.



RENAISSANCE AUSTIN HOTEL

9721 Arboretum Boulevard, Austin, TX 78759

512.343.2626 • Marriott.com/AUSSH

R
RENAISSANCE®
AUSTIN HOTEL

HOTEL OVERVIEW

We Are Here

Located less than two minutes from The Arboretum, nestled in the picturesque Texas Hill Countryside, our hotel provides a tranquil environment surrounded by nature trails. Plus, we're situated just 10 miles from downtown Austin in close proximity to local attractions like the University of Texas, Sixth Street, Austin Bergstrom International Airport and The Domain Shopping Center.

Accommodations

10 floors • 463 guest rooms • 85 suites • Plush pillowtop bedding • Spa-like bathrooms • Ergonomic workstations • High-speed Wi-Fi • 42-inch LCD TVs with access to premium movie and sports channels • Stylish décor including local artwork • Large windows with views of the Texas Hill Country • Certain guest rooms and suites offer access to the Club Lounge • Pets welcome • Mobility accessible rooms available

Sip & Savor

Knotty Deck & Bar - rooftop restaurant serving farm-to-table Texas cuisine and craft cocktails all day long, from the bar to the patio • @austinbytes – a casual café offering quick bites and freshly brewed coffee in the morning, along with made-to-order pizzas, sandwiches and local Austin beer in the afternoon/evening • Club Lounge offers complimentary breakfast and comfortable seating for club-level guests • Room service

Meetings & Events

24 indoor and outdoor venues across 70,000 square feet of event space • 18 maximum breakout rooms • Capacity for up to 1,800 people • High-speed Wi-Fi and cutting-edge audiovisual equipment • On-site event planning and catering teams

The Details

24-hour fitness center equipped with cardiovascular machines and free weights • Heated indoor pool • Seasonal outdoor pool • Whirlpool • Business center with copy, fax, messenger; post/parcel and overnight delivery/pickup services • Concierge desk • Giftshop/Newsstand • Valet dry cleaning • Car rental and limousine service • On-site parking, valet parking and electric car charging stations

Local Discoveries

Lake Travis and Lake Austin • University of Texas at Austin - home of the Longhorns • Sixth Street • State Capitol Building • Frank Erwin Center • Lady Bird Johnson Wildflower Center • The Arboretum at Great Hills • Gateway Shopping Center • Austin's Park • Laguna Gloria Art Museum

FLOOR PLANS

PLAZA LEVEL (Lower level)

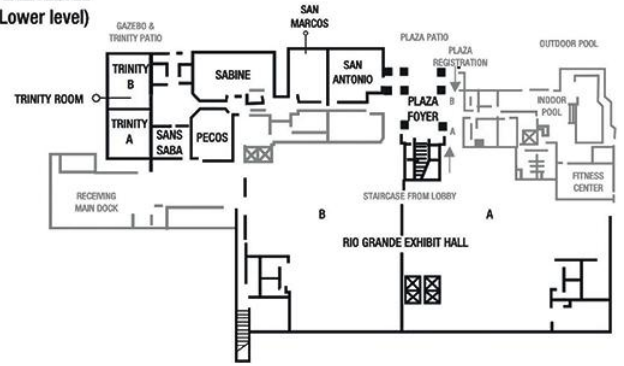

ATRIUM LEVEL (Lobby Level)



CAPACITY CHART

MEETING ROOM	LxWxH	SQ FT	THEATRE	CLASSROOM	CONFERENCE	U-SHAPE	RECEPTION	BANQUET
Nueces	30x25x11	750	65	32	24	25	50	50
Colorado Boardroom	13x27x11	350	–	–	8	–	–	–
Canadian Boardroom	13x27x11	350	–	–	8	–	–	–
Grand Ballroom	89x134x16	12,000	1,330	700	–	–	1,000	1,000
Grand Ballroom A	79x89x16	7,000	800	400	112	84	560	560
Grand Ballroom B	55x89x16	5,000	492	254	88	72	390	390
Wedgwood Ballroom	42x52x11	2,184	220	112	56	44	180	180
Blanco	42x52x13.5	2,184	–	–	14	–	–	–
Bosque	29x15x11	435	38	21	18	15	20	20
Concho	29x27x11	780	70	32	24	25	50	50
Frio	28x26x11	730	70	32	24	25	50	50
Guadalupe	25x23x11	575	50	24	18	20	40	40
Lobby Registration Booth	27x12x10	–	–	–	1	–	–	–
Brazos Auditorium	0x0x0	840	55	55	–	–	–	–
Atrium Alcove	0x0x0	2,000	–	–	–	–	200	190
The Arbo	0x0x0	2,500	–	–	–	–	220	220
Glass Oaks	0x0x0	5,454	400	195	58	70	350	350
San Antonio	39x29x11	1,131	140	66	26	30	90	90
San Marcos	31x30x11	930	104	54	24	26	80	80
Sabine	47x28x11	1,316	145	78	32	40	110	110
Pecos	31x36x11	1,100	120	60	24	30	80	80
San Saba	29x25x11	725	60	32	22	26	50	50
Trinity	85x30x11	2,550	280	144	–	58	190	190
Trinity A	30x40x11	1,200	127	66	30	34	90	90
Trinity B	30x40x11	1,200	127	66	30	34	90	90
Rio Grande Exhibit Hall	259x146x14.8	30,300	–	–	–	–	1,800	1,700
Rio Grande A	146x259x15	16,000	–	–	–	–	1,000	890
Rio Grande B	146x259x15	14,000	–	–	–	–	750	750
Plaza Registration Booth A	23x25x10	575	–	–	1	–	–	–
Plaza Registration Booth B	24x30.5x9	–	–	–	1	–	–	–
Plaza Registration Booth A & B	24x30.5x9	–	–	–	1	–	–	–
Trinity Patio	24x30.5x9	5,454	–	–	–	–	800	400