



MEET IN STYLISH MIDTOWN WHERE A SUITE DESTINATION AWAITS.

Discover more room for your event at Atlanta Marriott® Suites Midtown. Spread out in one of 254 spacious suites with private bedrooms, high-speed Internet access and Marriott Plug-In Technology for all your mobile devices. Prepare an event for up to 200 guests with 8,000 square feet of flexible meeting space and Marriott service attending to every detail. Then relax at the indoor/outdoor pool or stop by Grille 35 to sample the delectable American fare. It's all right here in a convenient Midtown location, close to museums, fine dining, entertainment and some of Atlanta's hottest attractions.

ACCOMMODATIONS

19 floors • 254 suites

RESTAURANTS & LOUNGES

Grille 35, Offers guests a full buffet or à la carte for breakfast, regional and standard American fare for lunch and dinner • In-Room Dining Service, Enjoy contemporary American cuisine in the privacy of your room for breakfast, lunch and dinner

RECREATION & LEISURE

Indoor/outdoor connecting pool •
24-hour fitness center • Golf nearby

ATTRACTIONS

High Museum of Art • Atlantic Station • Philips Arena • Piedmont Park • Woodruff Arts Center • Turner Field (Braves Baseball) • Georgia World Congress Center • Fox Theater • Georgia Aquarium • Georgia Dome • World of Coca-Cola • Centennial Olympic Park • Center for Civil and Human Rights • College Football Hall of Fame

GUEST SERVICES

High-speed Internet access in guest rooms •
Wireless Internet access in public spaces •
Complimentary WiFi in lobby

MEETING FACILITIES

11 meeting rooms • 8,000 square feet of total meeting space • Largest meeting room is Symphony 1, 2 & 3 (combined) with maximum meeting space of 2,250 square feet and maximum seating capacity of 200 •
Maximum of 5 breakout meeting rooms

LOCATION

Upscale, all-suite hotel in the heart of Atlanta's Midtown neighborhood • Easy access to the Woodruff Arts Center, Piedmont Park, Georgia Tech, theaters, nightlife and Atlanta's finest restaurants • Close to MARTA, Atlanta's public rail system

Meeting Room	Dimensions		Capacity					
	W×L×H	Sq. Ft.	Theater	School Room	Conference	U-Shape	Reception	Banquet
Symphony 1, 2 or 3 (each)	25×30×10	750	50	40	30	30	50	60
Symphony 1, 2 & 3 (combined)	75×30×10	2,250	175	120	70	60	200	180
Theater 1, 2 or 3 (each)	23×20×10	460	30	15	15	12	40	30
Theater 1, 2 & 3 (combined)	23×60×10	1,380	80	64	—	—	120	90
Playhouse 1 or 2 (each)	23×19×10	437	30	20	20	16	40	30
Playhouse 1 & 2 (combined)	40×23×10	920	50	30	—	—	80	60
Executive Boardroom	23×19×10	437	—	—	10	—	—	—
Gallery 1	15×23×11	345	20	12	15	12	25	20
Gallery 2	18×22×11	396	40	18	20	16	40	30
Gallery 3	22×38×11	836	60	30	36	32	100	50
Gallery 2 & 3 (Museum Ballroom)	40×38×11	1,520	80	60	—	—	130	90

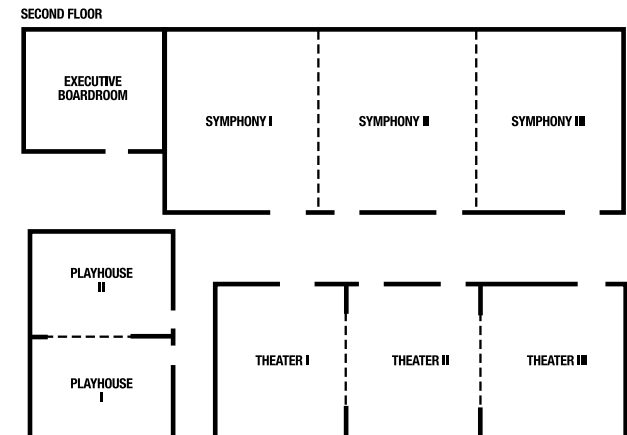
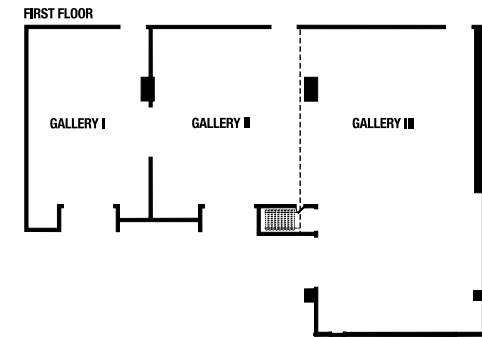

ATLANTA MARRIOTT® SUITES MIDTOWN

35 14TH STREET NE ATLANTA, GEORGIA 30309

404.876.8888 ATLANTAMARRIOTTSSUITESMIDTOWN.COM

f /AtlantaMarriottSuitesMidtown @MarriottMidtown /MarriottMidtown