

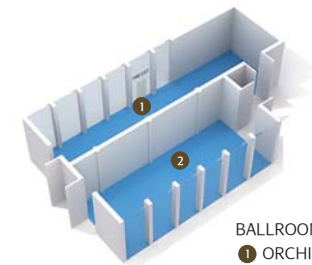

MEET YOU THERE

Irresistibly combining the best of both worlds, Pattaya offers a wealth of attractions to keep both delegates and their spouses happily engaged. Benefiting from a prime town center location, Pattaya Marriott Resort & Spa faces the ocean yet is just steps away from the best shopping and entertainment outlets. Specializing in corporate event management, a ballroom with capacity for up to 300 people, extensive function rooms, beautiful landscaped gardens and a wealth of dining options cater for every eventuality, from a leisurely scenic reception, small conference with private dinner party, to a large scale presentation with accompanying banquet.

Indoor Meeting & Function Space	Dimension (W x L x H) Meter	Area (Sq. m.)	Theater	Class Room	U-shape	Board Room	Cocktail Reception	Banquet
Ballroom	24 x 16 x 3	384	300	200	60		300	250
Orchid Garden	24 x 8 x 3	192	150	130	40	80	180	100
Rose Garden	20 x 8 x 3	160	120	100	40	80	150	80
Rice Mill	15 x 9 x 2.75	144	60	40	24	50	60	80
Chaba	16 x 5 x 2.75	80	50	40		30	40	40
Sala Rim Nam							300	120
Tropical Garden	Open air by the pool						150	80



BALLROOM
 1 ORCHID GARDEN
 2 ROSE GARDEN



RICE MILL

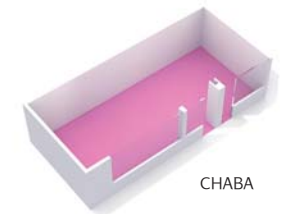

CHABA

LOCATION

Located in the heart of Pattaya overlooking the beach and the Gulf of Siam. Set over 8 acres surrounded by tropical gardens yet steps away from the best shopping and entertainment Pattaya has to offer.

DIRECTIONS

After leaving the arrival terminal, stay on the right side of the highway • Follow the directional signs to Bangkok - Chonburi Motorway, pass the toll gate • Follow the directional signs to Chonburi - Pattaya • Follow the directional signs to Pattaya, pass the toll gate • Follow the directional signs to Pattaya-Rayong • Leave the motorway at the exit Pattaya • When entering Pattaya from either north or south on the Sukhumvit highway, take the South Pattaya (Pattaya Tai) exit • Follow the South Pattaya Road to the end • Turn right at the traffic lights onto Pattaya Second Road • The resort is located on the left, 500 meters from the traffic lights

ACCOMMODATIONS

298 rooms, including 30 suites • Air conditioning • Tea and coffee making facilities • LCD TV with satellite feed and pay-per-view movies • Non smoking rooms • Crib • In-room high speed internet access from LAN or WiFi

GUEST SERVICES

Concierge • Business center • High speed internet access including WiFi • Express check-in and check-out • Limousine service • Laundry service • Tour and travel desk • Car parking with valet service • Babysitting • Meeting and wedding facilities

RESTAURANTS & LOUNGES

Benihana - Japanese steakhouse with teppanyaki tables • **Garden Cafe** - Classic international cuisine and Thai dishes. Nightly BBQ buffet • **Numero Uno** - Daily fresh pastries and coffees • **Elephant Bar** - Relaxed open air lobby lounge with live entertainment • **Manao Bar** - BBQ, snacks, salads and drinks by the pool or at swim up bar

RECREATION & LEISURE

Royal Garden Spa (5 treatment rooms) • Fitness and aerobics center • Floodlit tennis courts • Tropical swimming pool and jacuzzi • 18 golf courses nearby • Adjoining Royal Garden shopping plaza • Ripley's Believe It or Not! museum and entertainment complex

MEETING & BANQUET FACILITIES

384 sq. m. dividable ballroom with seating 300 theatre style • Four meeting rooms for 10 – 15 people with full range audio visual • Extensive outside catering service for up to 3,000 people

NEARBY ATTRACTIONS

Ripley's Believe It or Not! museum • The Sanctuary of Truth • Pattaya Floating Market