

MAKE YOUR MARK WHERE THE WHOLE WORLD MEETS.



Hold your event at the New York Marriott in Times Square and be in the heart of the excitement of New York City. Whether you're planning a national conference, a corporate gala or simply a client presentation, it's the perfect place to make a great impression on your attendees. Select from over 66 event rooms, from intimate meeting suites to the stunning 29,000 square foot Broadway Ballroom. In all, there's more than 100,000 square feet of meeting space. We've earned the Gold Key Award from *Meetings and Conventions* and the Award of Excellence from *Corporate & Incentive Travel*. With the help of our talented and creative event management team, you'll win some major accolades too.

NEW YORK MARRIOTT MARQUIS

1535 Broadway
New York, New York 10036
Phone 212-398-1900
Fax 212-704-8930
NYMarriottMarquis.com

FOURTH FLOOR

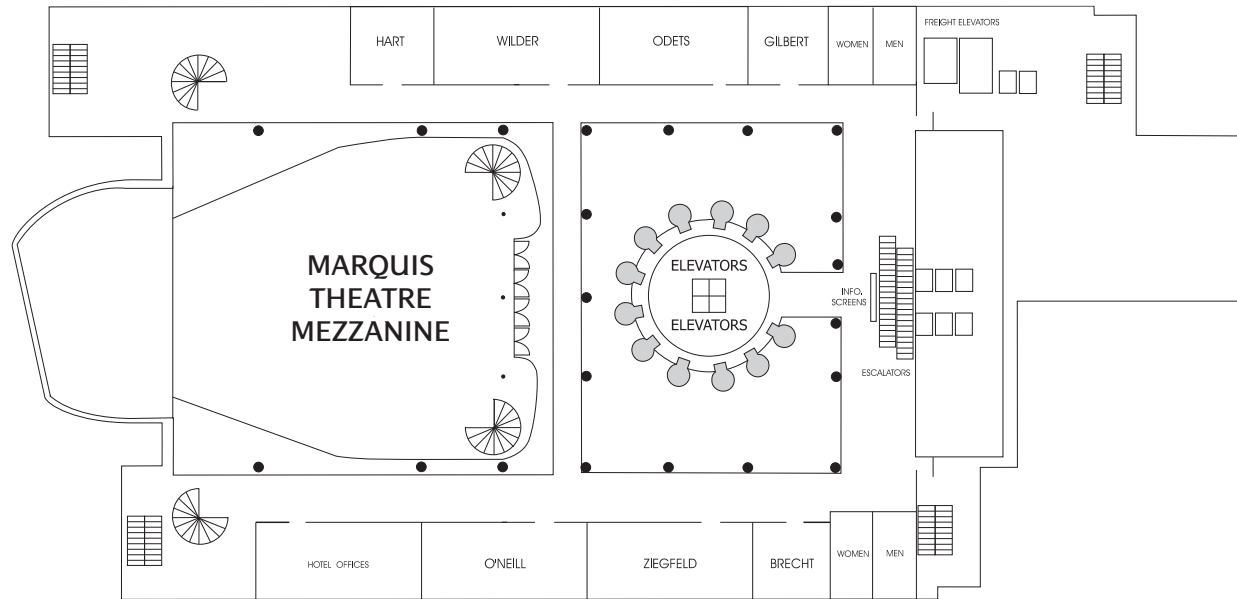

Meeting Room	Dimensions		Capacity					
	L×W×H	Sq. Ft.	Theater	Schoolroom	Conference	U-Shape	Reception	Banquet
FOURTH FLOOR								
Hart	28x24x12	672	60	40	26	26	50	50
Odets	56x24x12	1,344	120	80	45	45	100	90
Wilder	56x24x12	1,344	120	80	45	45	100	90
Gilbert	24x24x12	576	60	40	26	26	50	50
Brecht	24x26x10	624	60	40	22	23	50	40
Ziegfeld	50x26x10	1,300	120	80	45	45	100	90
O'Neill	57x26x10	1,482	120	80	45	45	100	90

FIFTH FLOOR

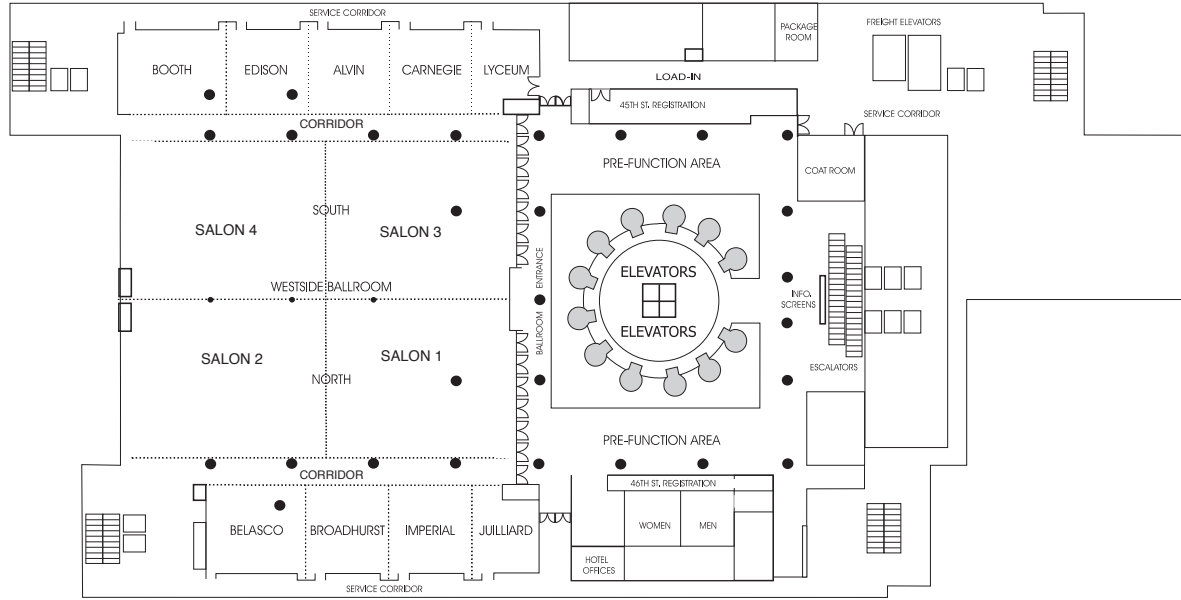

Meeting Room	Dimensions		Capacity					
	LxWxH	Sq. Ft.	Theater	Schoolroom	Conference	U-Shape	Reception	Banquet
FIFTH FLOOR								
Westside Ballroom	182x124x12	22,568	1,900	1,050	—	—	2,400	1,650
Westside Ballroom North & South Centers (combined)	108x124x12	13,392	1,450	850	—	—	1,500	1,000
Westside North Center	108x62x12	6,696	680	400	—	—	600	500
Westside North Entire			950	500	—	—	1,200	800
Westside South Center	108x62x12	6,696	680	400	—	—	600	500
Westside South Entire			1,150	525	—	—	1,200	850
Pre-Function			—	—	—	—	500	—
Lyceum	26x26x10	676	60	36	26	24	50	40
Lyceum Complex (including corridor)	142x36x10	5,112	300	160	—	—	400	280
Carnegie	26x26x10	676	65	40	26	24	75	50
Alvin	29x26x10	754	65	40	28	24	75	50
Edison	28x26x10	728	60	36	28	24	60	50
Booth	33x26x10	858	60	36	28	24	60	40
Julliard Complex (including hallway)	113x36x10	4,068	280	160	—	—	350	270
Julliard	24x26x10	624	50	36	26	24	50	40
Imperial	30x26x10	780	65	40	28	24	75	50
Broadhurst	29x26x10	754	65	40	28	24	75	50
Belasco	29x26x10	754	60	36	28	24	60	50

SIXTH FLOOR

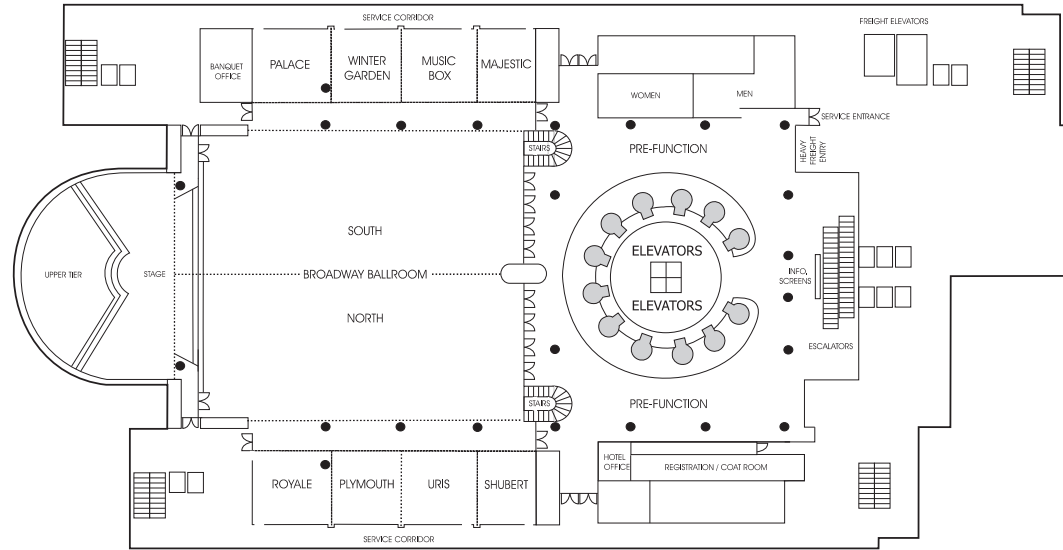

Meeting Room	Dimensions		Capacity					
	LxWxH	Sq. Ft.	Theater	Schoolroom	Conference	U-Shape	Reception	Banquet
SIXTH FLOOR								
Broadway Ballroom (including balcony)			2,500	1,500	—	—	2,800	2,400
Broadway Ballroom North & South Center (excluding balcony)	108x118x23	12,744	1,600	1,000	—	—	1,700	1,100
Broadway Ballroom North Center	54x118x23	6,372	800	475	—	—	900	550
Broadway Ballroom North Entire (including breakouts)			1,180	650	—	—	1,250	710
Broadway Ballroom South Center	54x118x23	6,372	800	475	—	—	900	550
Broadway Ballroom South Entire (including breakouts)			1,100	650	—	—	1,250	710
Pre-Function			—	—	—	—	600	—
Majestic Complex (including hallway)	101x37x10	3,737	275	160	—	—	350	270
Majestic	21x25x10	525	60	40	26	24	50	40
Music Box	26x25x10	650	60	40	26	28	60	40
Winter Garden	26x25x10	650	60	40	26	28	60	40
Palace	28x25x10	700	60	40	26	24	45	40
Shubert Complex (including hallway)	104x37x10	3,848	275	160	—	—	350	270
Shubert	21x25x10	525	50	40	26	26	50	220
Uris	27x25x10	675	60	40	26	28	60	40
Plymouth	27x25x10	675	60	40	26	28	60	40
Royale	29x25x10	725	60	40	26	24	45	40

SEVENTH FLOOR

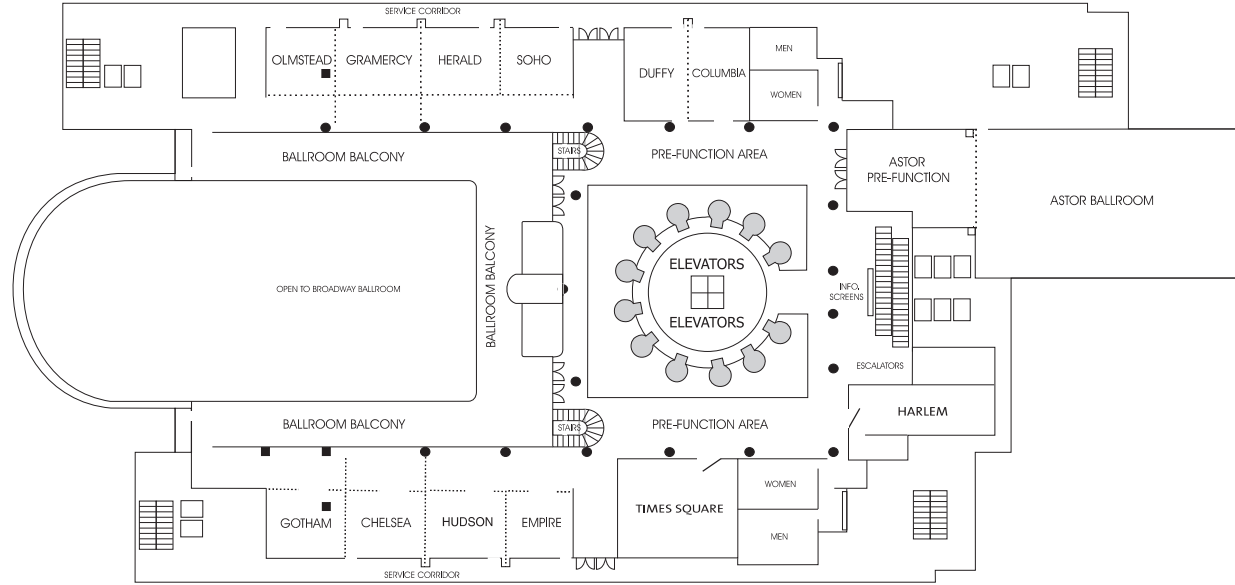

Meeting Room	Dimensions		Capacity					
	LxWxH	Sq. Ft.	Theater	Schoolroom	Conference	U-Shape	Reception	Banquet
SEVENTH FLOOR								
Broadway Ballroom Balcony			300	200	—	—	—	280
Seventh Floor Pre-Function			—	—	—	—	400	—
Astor Ballroom	53x86x10	4,558	500	275	—	—	600	400
Astor Pre-Function			150	60	40	45	100	100
Astor/Pre-Function (combined)			650	300	—	—	700	470
Soho Complex	79x23x10	1,817	175	100	—	60	175	120
Soho Complex (including hallway)			275	140	—	75	225	210
Soho	28x22x10	616	60	40	28	28	60	50
Gramercy	26x23x10	598	60	40	28	28	40	40
Olmstead	35x28x10	980	85	60	38	38	70	60
Empire Complex	83x23x10	1,909	175	100	—	60	175	120
Empire	28x22x10	616	60	40	28	28	40	40
Hudson	28x22x10	616	60	40	28	28	40	40
Chelsea	27x23x10	621	60	40	28	28	40	40
Gotham	26x25x10	650	50	35	26	26	50	50
Herald	28x23x10	644	60	40	28	28	40	40
Times Square	26x30x10	780	65	40	32	35	80	80
Harlem	18x49x10	882	75	40	30	22	50	50
Duffy	30x25x10	750	75	40	26	26	60	60
Columbia	30x17x10	510	40	30	26	26	50	50
Duffy/Columbia (combined)	42x30x10	1,260	130	75	36	45	120	110

EIGHTH FLOOR

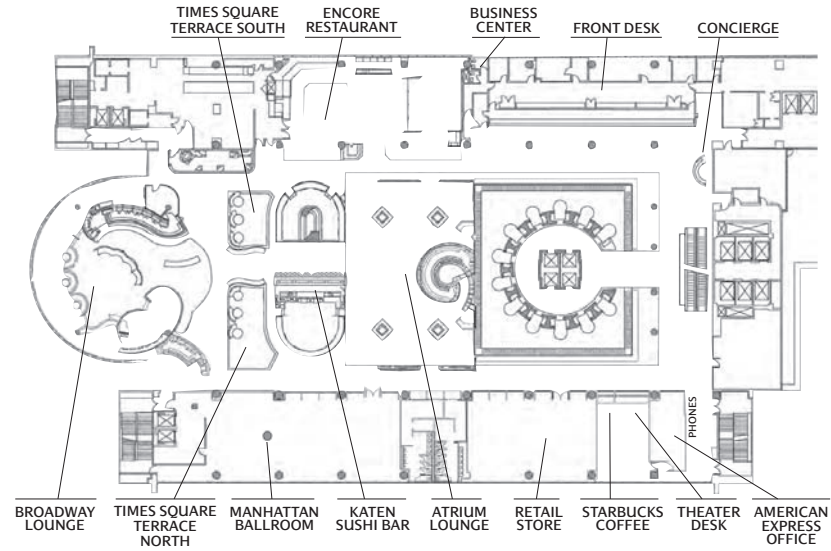

Meeting Room	Dimensions		Capacity					
	LxWxH	Sq. Ft.	Theater	Schoolroom	Conference	U-Shape	Reception	Banquet
EIGHTH FLOOR								
Manhattan Ballroom	80x40x10	3,200	225	110	30	30	300	200

SIXTEENTH FLOOR



Meeting Room	Dimensions		Capacity					
	LxWxH	Sq. Ft.	Theater	Schoolroom	Conference	U-Shape	Reception	Banquet
SIXTEENTH FLOOR								
Sky Lobby	26x107	2,782	—	—	—	—	180	140

NINTH FLOOR

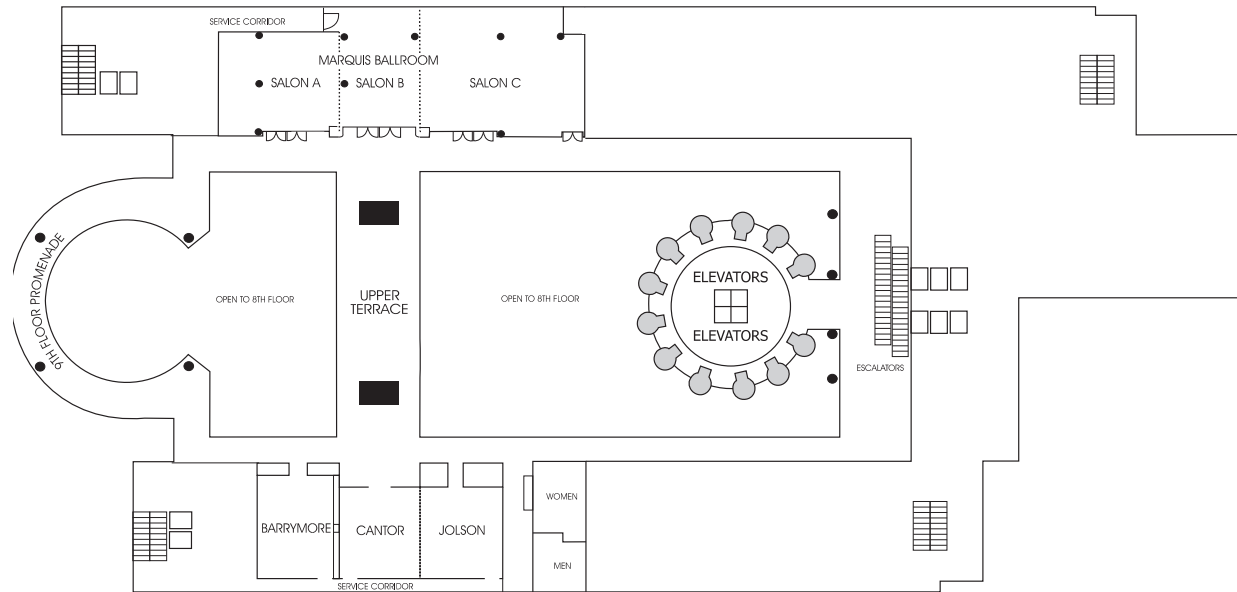

Meeting Room	Dimensions		Capacity					
	L×W×H	Sq. Ft.	Theater	Schoolroom	Conference	U-Shape	Reception	Banquet
NINTH FLOOR								
Marquis Ballroom			350	220	—	—	375	310
Salon A	38x35x9	1,330	70	50	26	28	60	60
Salon B	39x33x9	1,287	100	60	26	28	90	90
Salon C	44x52x9	2,288	200	140	44	48	225	160
Barrymore	26x33x9	858	—	—	18	—	—	—
Cantor	28x30x9	840	80	40	26	26	80	70
Jolson	25x30x9	750	70	35	26	26	60	60
Cantor/Jolson (combined)	53x30x9	1,590	125	75	40	45	125	130



ACCOMMODATIONS

49 floors • 1,892 rooms • 57 suites • 2 concierge levels and a concierge lounge • Marble bathrooms • Individual climate control • 37" flat-screen TV • Cable TV with movie channels • Connectivity panel for high-speed Internet access • iPod clock radio • Two-line telephone • Complimentary in-room coffee and tea service • Luxurious bedding • Safe • Iron and ironing board • Service animals allowed for persons with disabilities • Smoke-free hotel policy

RESTAURANT & LOUNGES

The View Restaurant and Lounge: enjoy stunning views of New York and a great continental menu in the city's only revolving rooftop restaurant (dinner) • Encore Restaurant: American cuisine (breakfast, lunch, and dinner) • Atrium Lounge: cocktails and light fare under a soaring 37-story atrium • Katen Sushi Bar: fresh Japanese sushi (lunch, dinner) • Broadway Lounge: Overlooks Times Square with eclectic food and beverage and weekly specials (dinner) • 2 Starbucks® locations

RECREATION AND LEISURE

4,000 sq. ft. state-of-the-art fitness center • Driving range, jogging trail and biking nearby

ATTRACTIONS

Broadway Theaters • Times Square • Central Park • Radio City Music Hall • Rockefeller Center • Intrepid Air and Space Museum

• Jacob K. Javits Convention Center • Madison Square Garden • Empire State Building • Statue of Liberty • Ellis Island • American Museum of Natural History/Rose Center for Earth and Space • Nokia Theatre • Restaurant Row • 5th Avenue Shopping • Macy's • ABC's Good Morning America

GUEST SERVICES

Concierge desk • Full-service business center • Room service 6:00 a.m. – 2:00 a.m. • Safe deposit boxes • Boarding pass printer • Transportation kiosk for airport transfers • American Express desk/currency exchange • Theatre desk • Retail store (gift shop) • ATM machine • 1600-seat Marquis Theatre • Shoe shine stand • Valet dry cleaning • Complimentary daily newspaper

MEETING FACILITIES

66 meeting rooms • 101,450 sq. ft. of total meeting space • Largest venue is the Broadway Ballroom with a full production stage which has 29,025 sq. ft. of meeting space • Westside Ballroom with a capacity for 150 8x10 booths, maximum meeting space of 22,568 sq. ft. • Astor Ballroom is ideal for mid-sized meetings, and The Marquis Ballroom for more intimate events • Manhattan Ballroom for intimate dinners and receptions • Wired and wireless high-speed Internet • Online event planning tools • Full service onsite audio-visual equipment and service • Video conferencing • Award-winning, creative and personalized menus • QuickGroup booking tool

NEW YORK MARRIOTT MARQUIS

1535 Broadway
New York, New York 10036
Phone 212-398-1900
Fax 212-704-8930
NYMarriottMarquis.com