

# conference & events

**Marriott**  
LONDON MAIDA VALE



Conference Foyer



Carlton Room



Hamilton Room

The hotel has six meeting rooms, the largest being the Regent Suite with a maximum seating capacity of 180 people. Giving our guests the highest quality service is paramount to us and we have a long and proud record of successful events that have been held at the hotel.

- The **Regent Suite** has natural daylight and can be sub-divided into 1, 2, 3 or 4 different rooms. Each has soundproof moveable walls, making it an ideal venue for training seminars, conferences and events.
- The **Hamilton Room** has natural daylight and seats up to 24 people theatre style.
- The **Carlton Room** with its natural daylight and video conferencing facility is ideal for training courses and meetings.

Meeting Room	Dimensions LxWxH (metres)	Area Sq.Mtr.	Theatre	Cabaret	Classroom	Boardroom	U-Shape	Dinner	Dinner Dance	Reception
Regent Suite	15 x 12 x 4	170	180	80	70	–	–	140	120	200
Regent 1&2 or 3&4	12 x 7 x 4	84	80	35	40	30	30	50	40	80
Regent Suite 1	7 x 7 x 4	50	30	16	12	16	12	18	–	30
Regent Suite 2	7 x 6 x 4	40	30	16	12	16	12	18	–	30
Regent Suite 3	7 x 5 x 4	34	16	10	12	10	10	10	–	16
Regent Suite 4	7 x 4 x 4	26	12	–	–	10	–	–	–	12
Carlton Room	8 x 6 x 3	43	30	16	16	20	16	20	–	30
Hamilton Room	8 x 4 x 3	32	24	16	12	16	12	18	–	24

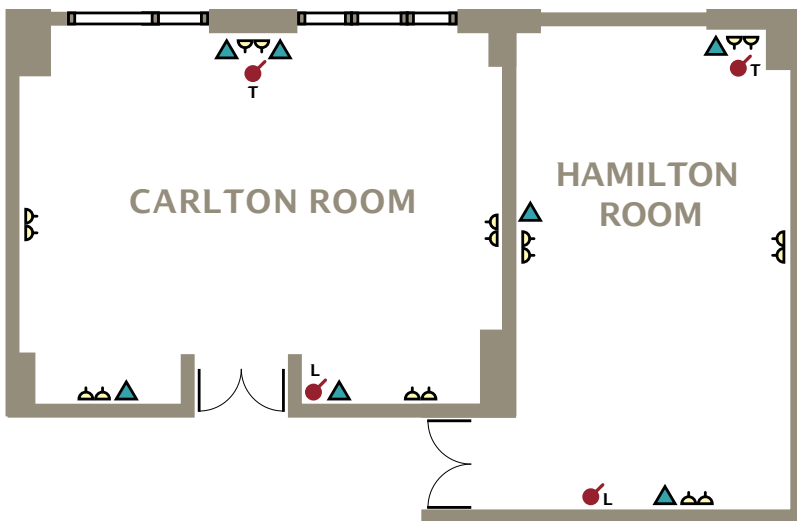
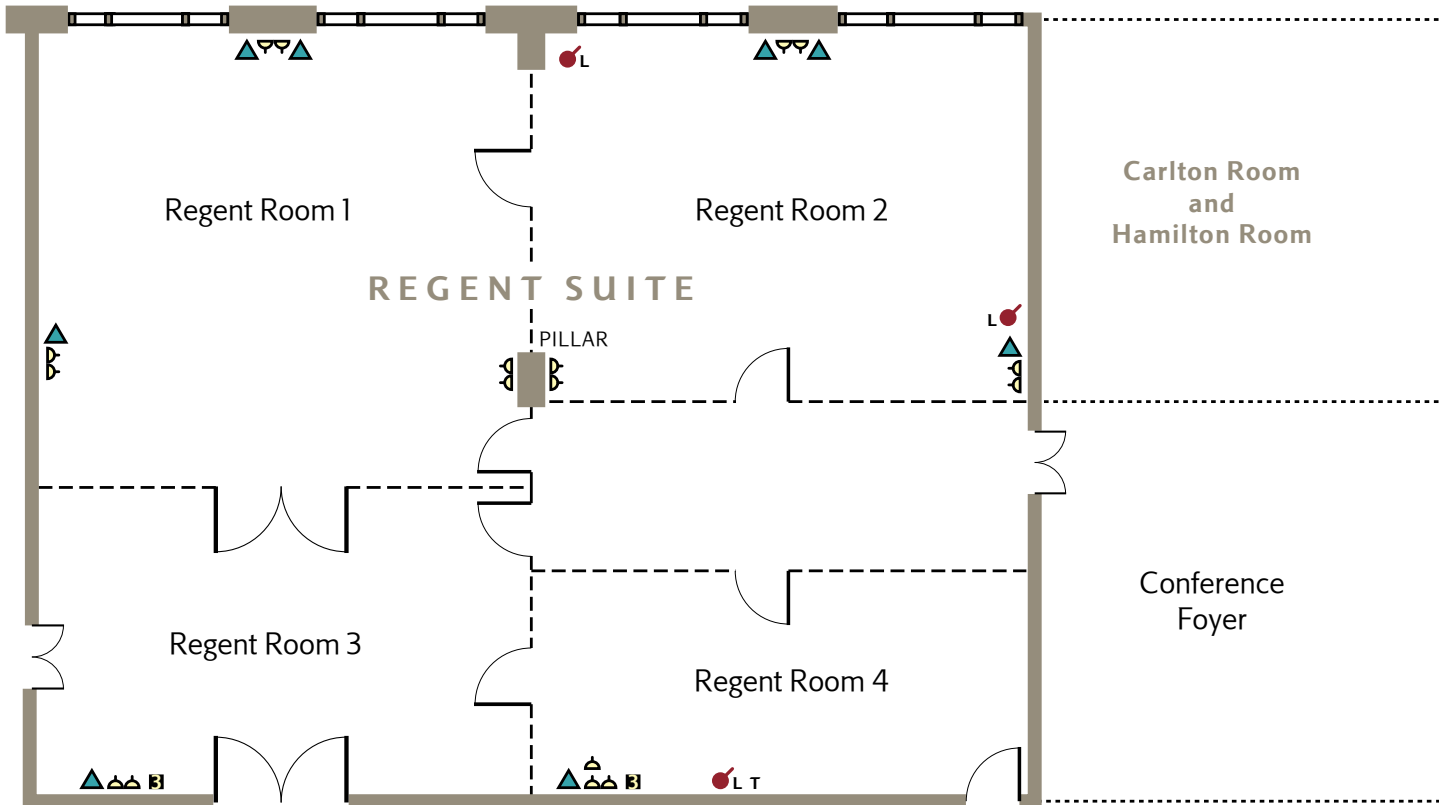

- L Lighting
- T Temperature
- Power points (13 amp)
- Three-phase power supply
- Telephone/fax point
- Window
- Acoustic moveable screen

0 1 2 3 4  
Scale (metres)