

The King George V & Queen Mary Rooms

The largest of which can accommodate up to 80 delegates theatre style and 60 for private dinners. The interconnecting Queen Mary Room is ideal as a registration, refreshments or pre dinner drinks area.



The Horace Cutler, Ralph Knott and Francis Anderton Rooms

Accommodating up to 16 delegates boardroom style, these three rooms offer different styles to cater for different tastes – from the formal wood-panelled Ralph Knott with its marble fireplace, to the bright and elegant Horace Cutler and informal and relaxing atmosphere of the Francis Anderton, with its access to a private terrace overlooking the hotel's inner Courtyard.

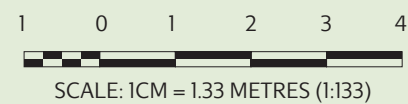
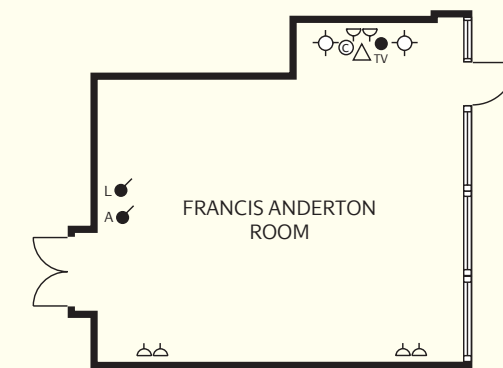
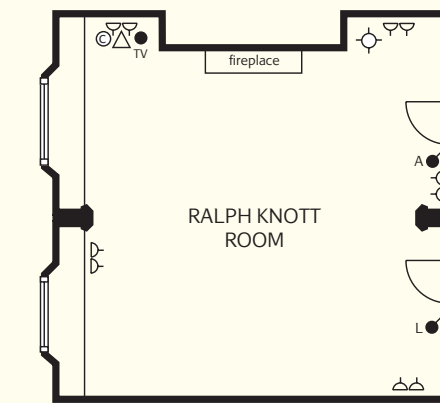
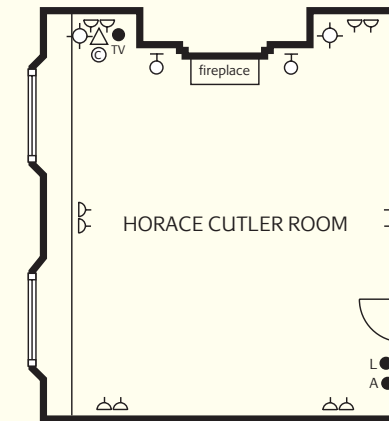
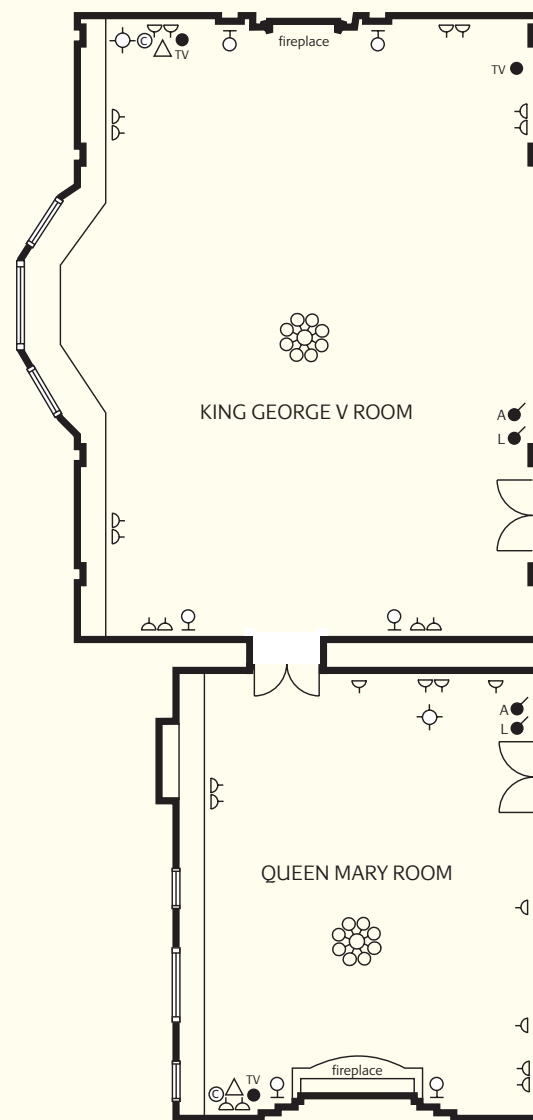

- A ● AUDIO
- V ● VENTILATION
- L ● LIGHTING
- H ● HEATING
- MIC MICROPHONE POINT
- FLOOR OR TABLE LIGHT
- △ POWER POINT - 13 AMP
- ⊙ COMPUTER POINT
- △ TELEPHONE - ISDN LINE
- WALL LIGHT
- ⊗ FEATURE LIGHT
- △ TELEPHONE/FAX POINT
- - - ACOUSTIC MOVEABLE SCREEN
- ▬ WINDOW OR GLAZED SCREEN

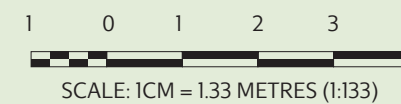

- A ● AUDIO
- V ● VENTILATION
- L ● LIGHTING
- H ● HEATING
- MIC MICROPHONE POINT
- FLOOR OR TABLE LIGHT
- △ POWER POINT - 13 AMP
- ⊙ COMPUTER POINT
- △ TELEPHONE - ISDN LINE
- WALL LIGHT
- ⊗ FEATURE LIGHT
- △ TELEPHONE/FAX POINT
- - - ACOUSTIC MOVEABLE SCREEN
- ▬ WINDOW OR GLAZED SCREEN

The Parliament Suite

Situated on the 5th floor of the hotel, with unsurpassed views across the Thames, to Big Ben and the Houses of Parliament, the aptly named Parliament Suite is a self-contained function room, with dedicated rest rooms, cloakroom and kitchen, accommodating up to 70 theatre style and 90 for a cocktail reception.



The William Wordsworth Room

Offering state-of-the-art equipment, including a wall-mounted plasma screen television, sympathetically combined with the original features of County Hall, to offer an elegant venue accommodating up to 14 delegates round the fixed boardroom table, overlooking the inner courtyard.

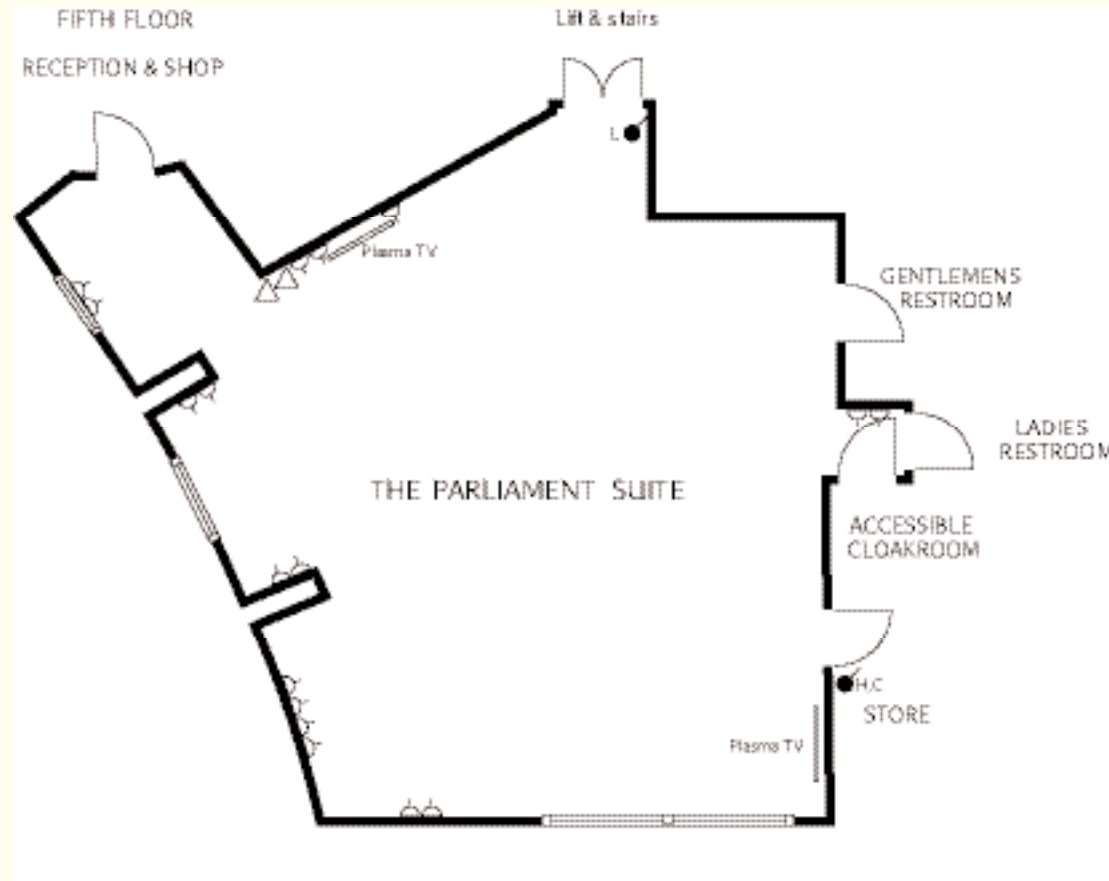

1 0 1 2 3 4

SCALE: 1CM = 1.33 METRES (1:133)

- | | |
|------------------------|----------------------------------|
| A ● AUDIO | Ⓢ COMPUTER POINT |
| V ● VENTILATION | △ TELEPHONE - ISDN LINE |
| L ● LIGHTING | Ⓞ WALL LIGHT |
| H ● HEATING | ⊗ FEATURE LIGHT |
| ● MIC MICROPHONE POINT | △ TELEPHONE/FAX POINT |
| ○ FLOOR OR TABLE LIGHT | - - - - ACOUSTIC MOVEABLE SCREEN |
| △ POWER POINT - 13 AMP | ▬ WINDOW OR GLAZED SCREEN |

1 0 1 2 3 4

SCALE: 1CM = 1.33 METRES (1:133)

- | | |
|------------------------|----------------------------------|
| A ● AUDIO | Ⓢ COMPUTER POINT |
| V ● VENTILATION | △ TELEPHONE - ISDN LINE |
| L ● LIGHTING | Ⓞ WALL LIGHT |
| H ● HEATING | ⊗ FEATURE LIGHT |
| ● MIC MICROPHONE POINT | △ TELEPHONE/FAX POINT |
| ○ FLOOR OR TABLE LIGHT | - - - - ACOUSTIC MOVEABLE SCREEN |
| △ POWER POINT - 13 AMP | ▬ WINDOW OR GLAZED SCREEN |

Herbert Morrison Room

This wood panelled room with a marble fireplace is perfect for meetings up to 42 delegates or private dinners for up to 30. As with all our private rooms, it offers natural daylight and it is fully air-conditioned



The Boardroom & Lady Nathan Room

The fixed wood-polished table and comfortable leather chairs make the Boardroom an ideal venue for executive meetings or private dinners. The interconnecting Lady Nathan Room offers a separate area for refreshments or pre dinner drinks.

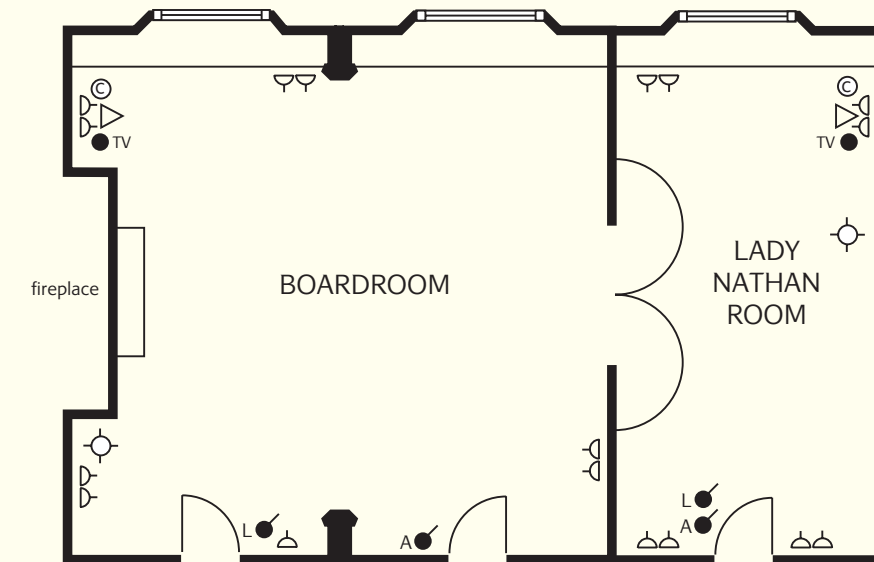
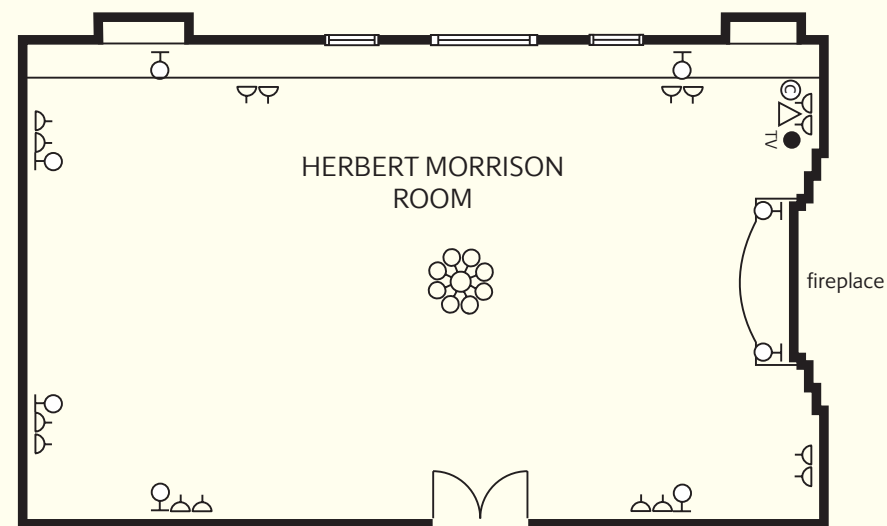

- | | |
|------------------------|--------------------------------|
| A ● AUDIO | Ⓞ COMPUTER POINT |
| v ● VENTILATION | △ TELEPHONE - ISDN LINE |
| L ● LIGHTING | Ⓚ WALL LIGHT |
| H ● HEATING | ⊗ FEATURE LIGHT |
| ● MIC MICROPHONE POINT | △ TELEPHONE/FAX POINT |
| ○ FLOOR OR TABLE LIGHT | - - - ACOUSTIC MOVEABLE SCREEN |
| △ POWER POINT - 13 AMP | ▬ WINDOW OR GLAZED SCREEN |

- | | |
|------------------------|--------------------------------|
| A ● AUDIO | Ⓞ COMPUTER POINT |
| v ● VENTILATION | △ TELEPHONE - ISDN LINE |
| L ● LIGHTING | Ⓚ WALL LIGHT |
| H ● HEATING | ⊗ FEATURE LIGHT |
| ● MIC MICROPHONE POINT | △ TELEPHONE/FAX POINT |
| ○ FLOOR OR TABLE LIGHT | - - - ACOUSTIC MOVEABLE SCREEN |
| △ POWER POINT - 13 AMP | ▬ WINDOW OR GLAZED SCREEN |

The Library

Formerly the Member's Library, overlooking the river and Houses of Parliament, is one of the most noteworthy and evocative rooms in the hotel. All the original bookcases have been retained, along with the Edwardian light fittings, old oak panelling and magnificent open fireplaces.

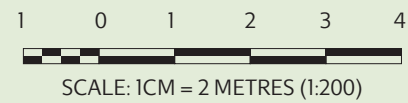
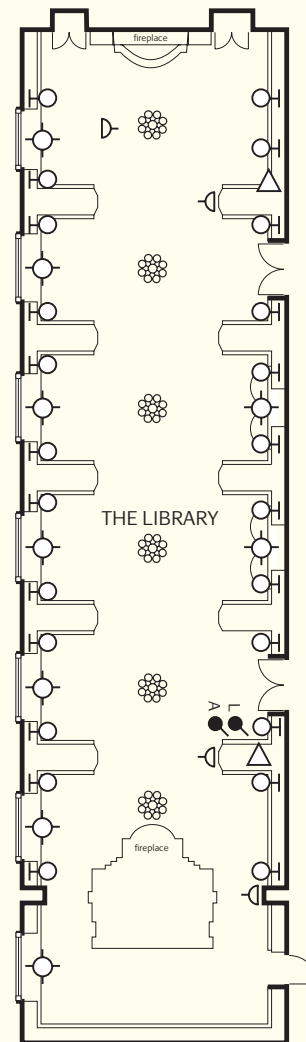

- | | | | |
|-------|----------------------|-------|--------------------------|
| ● A | AUDIO | Ⓢ | COMPUTER POINT |
| ● V | VENTILATION | Ⓣ | TELEPHONE - ISDN LINE |
| ● L | LIGHTING | Ⓛ | WALL LIGHT |
| ● H | HEATING | Ⓢ | FEATURE LIGHT |
| ● MIC | MICROPHONE POINT | Ⓣ | TELEPHONE/FAX POINT |
| ⊙ | FLOOR OR TABLE LIGHT | - - - | ACOUSTIC MOVEABLE SCREEN |
| Ⓛ | POWER POINT - 13 AMP | ▬▬▬ | WINDOW OR GLAZED SCREEN |

The Westminster Suite, our Presidential Suite

Features separate entrances to the bedroom and lounge area, making this an ideal room for small private dinners or receptions. Along with our Executive Suites, it is also suitable as a syndicate area and offers views over the river and Houses of Parliament.

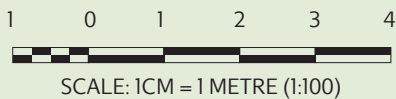
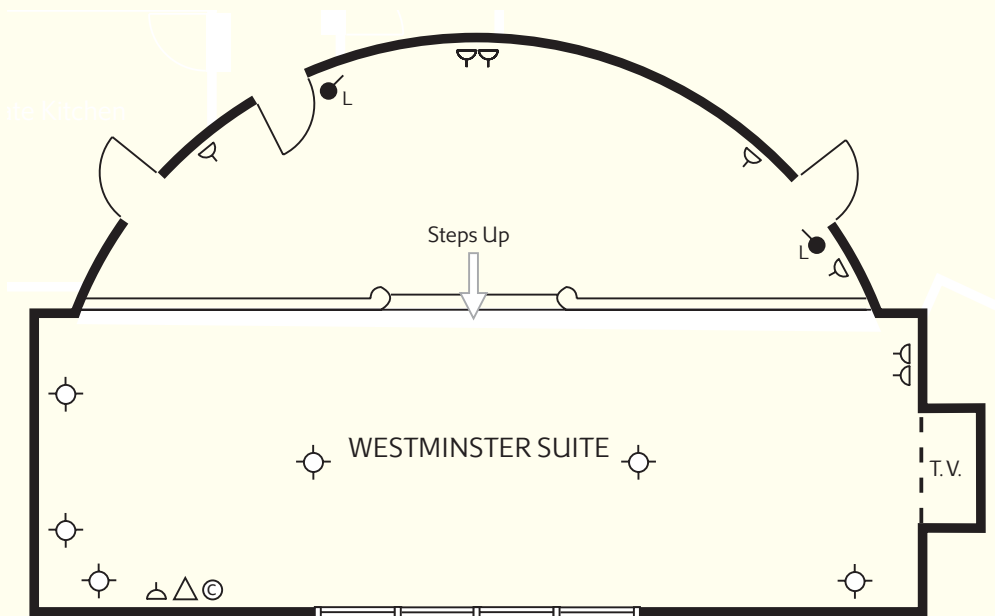

- A ● AUDIO
- V ● VENTILATION
- L ● LIGHTING
- H ● HEATING
- MIC MICROPHONE POINT
- FLOOR OR TABLE LIGHT
- △ POWER POINT - 13 AMP
- ⊙ COMPUTER POINT
- △ TELEPHONE - ISDN LINE
- ⊙ WALL LIGHT
- ⊙ FEATURE LIGHT
- △ TELEPHONE/FAX POINT
- - - ACOUSTIC MOVEABLE SCREEN
- ▬ WINDOW OR GLAZED SCREEN

Planning your Event with us at the London Marriott Hotel County Hall



This quick reference guide is designed to make planning your business event at the London Marriott Hotel County Hall as easy as possible. If you have any questions or would simply like some advice, please get in touch, we're here to help. You can either call us direct on 0870 400 7200 or email: events.countyhall@marriotthotels.co.uk. For online information and to download printable floorplans, visit Marriott.co.uk/meetingsandevents. While you're there, you can also browse through over 70 other Marriott properties across the UK.

	NATURAL DAYLIGHT	AIR COOLING	WHEELCHAIR ACCESS	DIMENSIONS(METRES)			MAXIMUM NUMBER OF DELEGATES						
				L	W	H	THEATRE STYLE	BOARDROOM STYLE	U-SHAPE	CLASSROOM STYLE	CABARET	COCKTAIL RECEPTION	DINNER
HERBERT MORRISON ROOM	3	3		10.45	6.15	4.29	42	22	23	32	24	54	30
QUEEN MARY ROOM	3	3		7.75	6.15	4.28	28	18	14	20	16	45	20
KING GEORGE V ROOM	3	3		10.80	7.80	4.12	80	30	30	40	40	90	60
RALPH KNOTT ROOM	3	3		6.75	6.95	4.12	30	16	14	20	14	28	16
BOARDROOM	3	3		7.10	6.95	4.12	-	12	-	-	-	-	12
LADY NATHAN ROOM	3	3		3.50	6.95	4.10	-	10	-	-	-	14	8
HORACE CUTLER ROOM	3	3		7.10	6.95	4.10	26	16	16	25	-	36	20
FRANCIS ANDERTON ROOM	3	3		6.00	6.45	3.70	24	16	14	16	14	30	16
THE LIBRARY	3	3		ON REQUEST			40	40	-	-	-	100	50
WESTMINSTER SUITE	3	3		ON REQUEST			12	8	-	-	-	30	-
WILLIAM WORDSWORTH ROOM	3	3		7.00	7.10	3.60	-	14	-	-	-	-	14
PARLIAMENT SUITE	3	3		9.00	12.00	2.40	70	25	28	40	40	90	60

QUICK REFERENCE GUIDE

NO. OF FLOORS	TOTAL NO. OF BEDROOMS	NON SMOKING BEDROOMS	STUDIOS & SUITES	DISABLED BEDROOMS	MARRIOTT COMMUNICATION SOLUTIONS AT THIS HOTEL	THE MARRIOTT BEDROOM (REFER TO HOTEL BROCHURE)	AIR COOLING IN BEDROOMS	INTERNET ACCESS IN BEDROOMS	MINI BAR IN BEDROOMS	IN ROOM SAFE	24 HR ROOM SERVICE	LAUNDRY SERVICE	SAFE DEPOSIT AT RECEPTION	SECRETARIAL SERVICES	BUSINESS CENTRE	EXECUTIVE LOUNGE	GIFT SHOP	VENDING MACHINES IN PUBLIC AREAS	ICE MACHINES ON ALL FLOORS	VALET PARKING	24 HOUR CONCIERGE	NUMBER OF PARKING SPACES
6	200	141	12	3	3	3	3	3	3	3	3	3	3	3	3	3	3	3	3	3	3	50

RESTAURANTS & LOUNGES	MARRIOTT LEISURE CLUB	PLACES TO SEE / THINGS TO DO
<ul style="list-style-type: none"> The County Hall Restaurant: Contemporary dining with fine food & wine. Rotunda bar: Light dining & cocktail venue. Leaders Bar: Champagne & Cigars Library Lounge: Traditional English afternoon tea 	<p>Complimentary: 25 metre pool and resident's gym.</p> <p>Supplementary: The Club @ County Hall and Health & Beauty spa.</p>	<ul style="list-style-type: none"> London Eye Dali Universe London Aquarium Tate Modern Houses of Parliament Saatchi Gallery

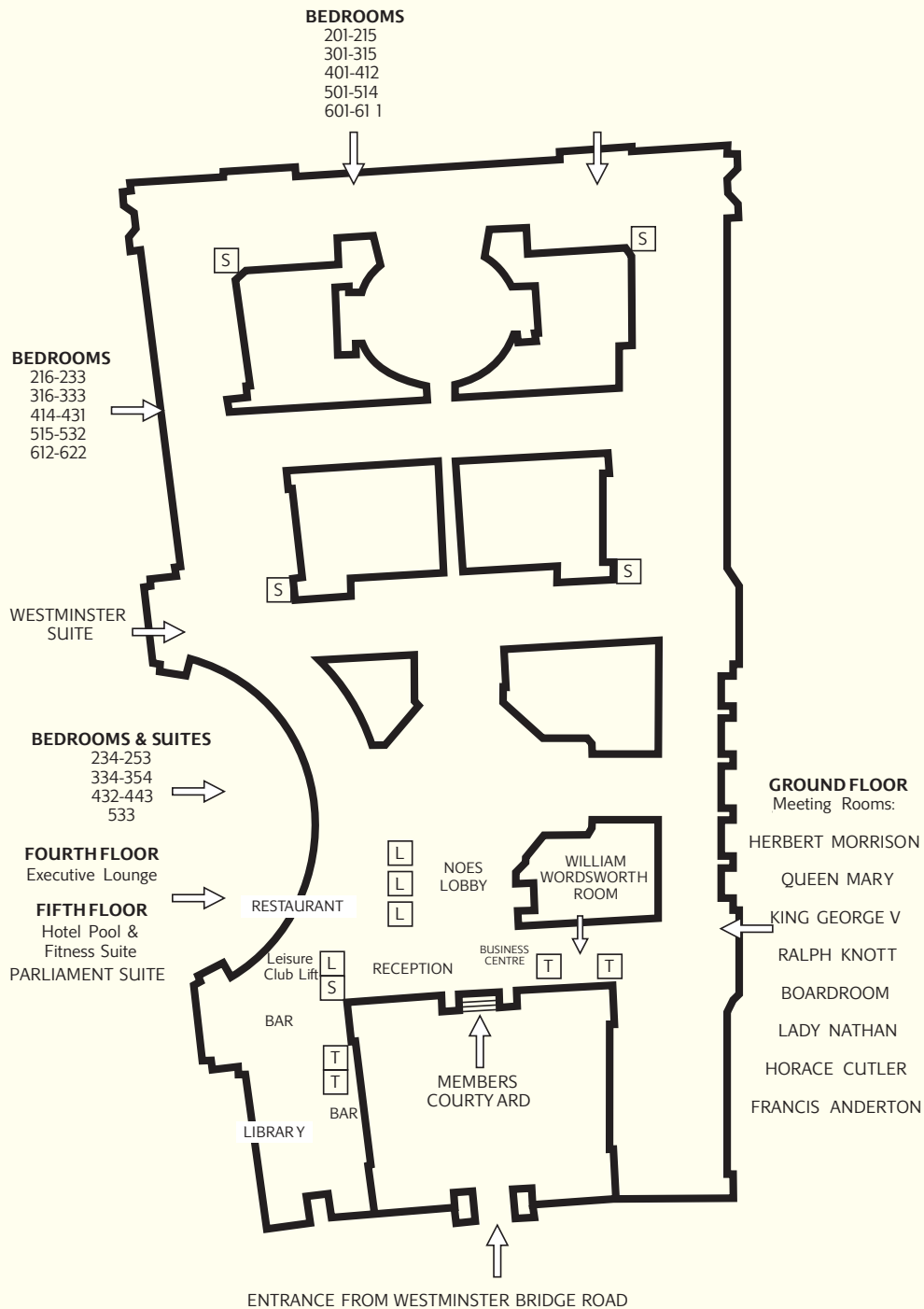

HOW TO FIND THE HOTEL

By road

The hotel is situated in the heart of London, on the River Thames opposite the Houses of Parliament and next to Westminster Bridge. The entrance to the hotel is on the south bank of Westminster Bridge, through the County Hall gates into the courtyard.

By rail

The nearest underground stations are Westminster and Waterloo (which is also the Eurostar terminal providing frequent rail connections to Paris and Brussels). For information on train times, please call the National Railway Enquiry Service on 08457 484950.

By air

London Heathrow (25 miles East): Take M4 to A4 towards central London. Follow signs to Westminster. The hotel is situated on the River Thames opposite the Houses of Parliament and next to Westminster Bridge.

London Gatwick (45 miles North): Take M23 to A23 towards central London. Follow signs to Westminster. The hotel is situated on the River Thames opposite the Houses of Parliament and next to Westminster Bridge.



Marriott
LONDON COUNTY HALL

Westminster Bridge Road, London SE1 7PB
Telephone 0870 400 7200 • Facsimile 0870 400 7300

LondonMarriottCountyhall.co.uk